



A strong link of your system

CARTRIDGE MECHANICAL SEALS SERIES "C"

Fluiten cartridge seals are designed with flexibility in mind, to suit a large number of applications.

This optimisation, reduces the need to carry extensive spare parts, normally associated with multiple variations in seal usage.

The choice of materials, and the careful attention to detail for every solution, are the reason behind the great success of the Fluiten 'C' type cartridge range. This range is now being use with confidence, and complete satisfaction, by major manufacturers of pumps and mixers.

This catalog shows the second generation of this range of cartridges with the last improvements according to the current security requirements of european community



- Single Seals C2K/C2KC/C2S
- Single Seals with throttle bushing C2SQ/C2DQ
- Double Seals C2D
- Seals with reinforced sleeve series "3"
- Dry-running seals C4D/C4DQ



SINGLE SEALS CHARACTERISTICS

C2K/C2KC/C3K/C3KC

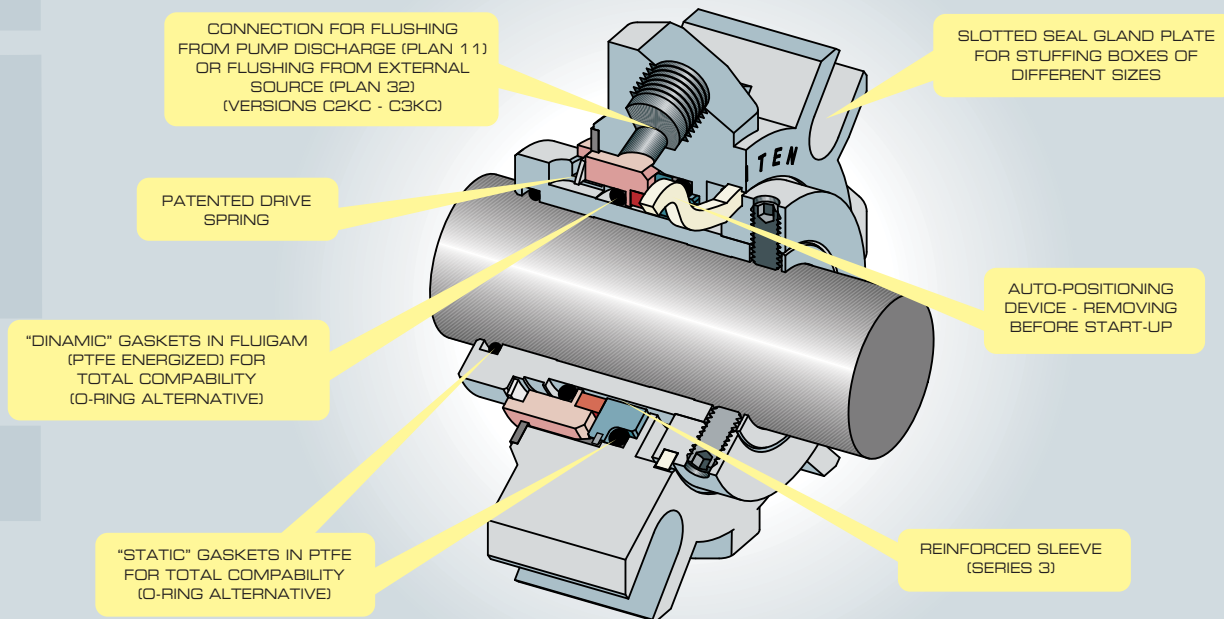

MATERIALS:

STATIONARY SEAT:

Silicon carbide

ROTARY FACE:

AISI 316+graphite

AISI 316+silicon carbide

GASKETS:

EPDM / FKM / PTFE (Fluigam)

Perfluoroelastomers (if request)

SPRING:

Superinox

OTHER METAL PARTS:

AISI 316

2

FLUITEN

C2S/C3S (C2SQ/C3SQ with throttle bushing for quench)

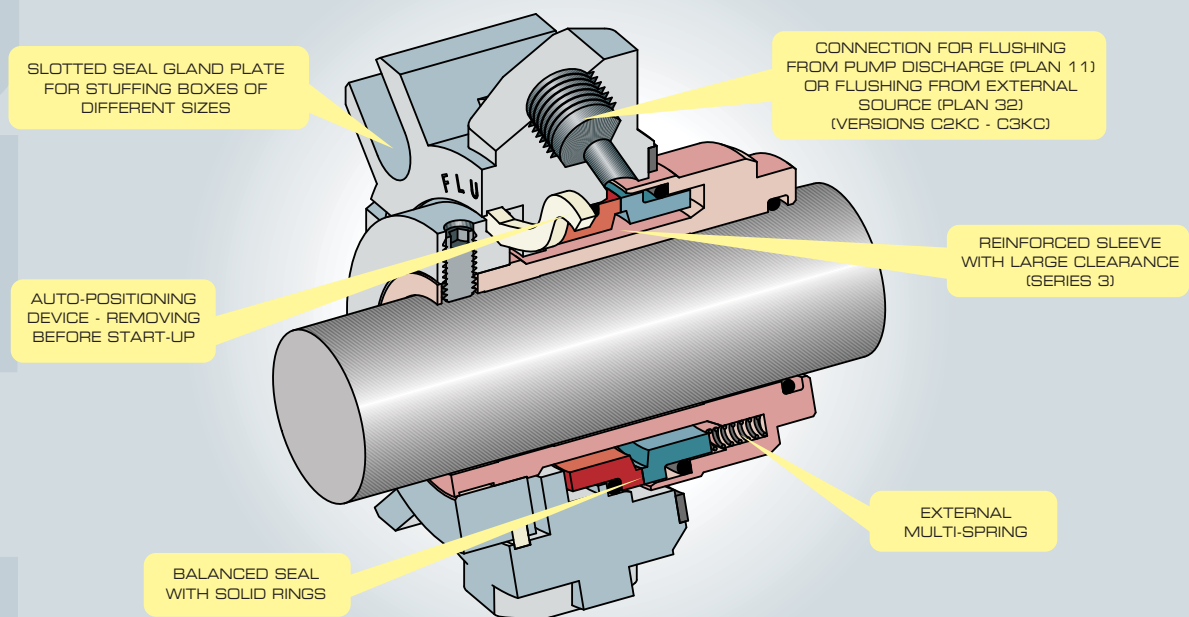

MATERIALS:

STATIONARY SEAT:

Graphite

Silicon carbide

Tungsten carbide

ROTARY FACE:

Silicon carbide

Tungsten carbide

GASKETS:

EPDM / FKM

Perfluoroelastomers

SPRINGS:

AISI 316

Hastelloy (if request)

THROTTLE BUSHING

(C2SQ-C3SQ):

Bronze

OTHER METAL PARTS:

AISI 316

Hastelloy (if request)

DOUBLE SEALS CHARACTERISTICS

C2D/C3D/C4D
(C2DQ/C3DQ/C4DQ with throttle bushing for quench)

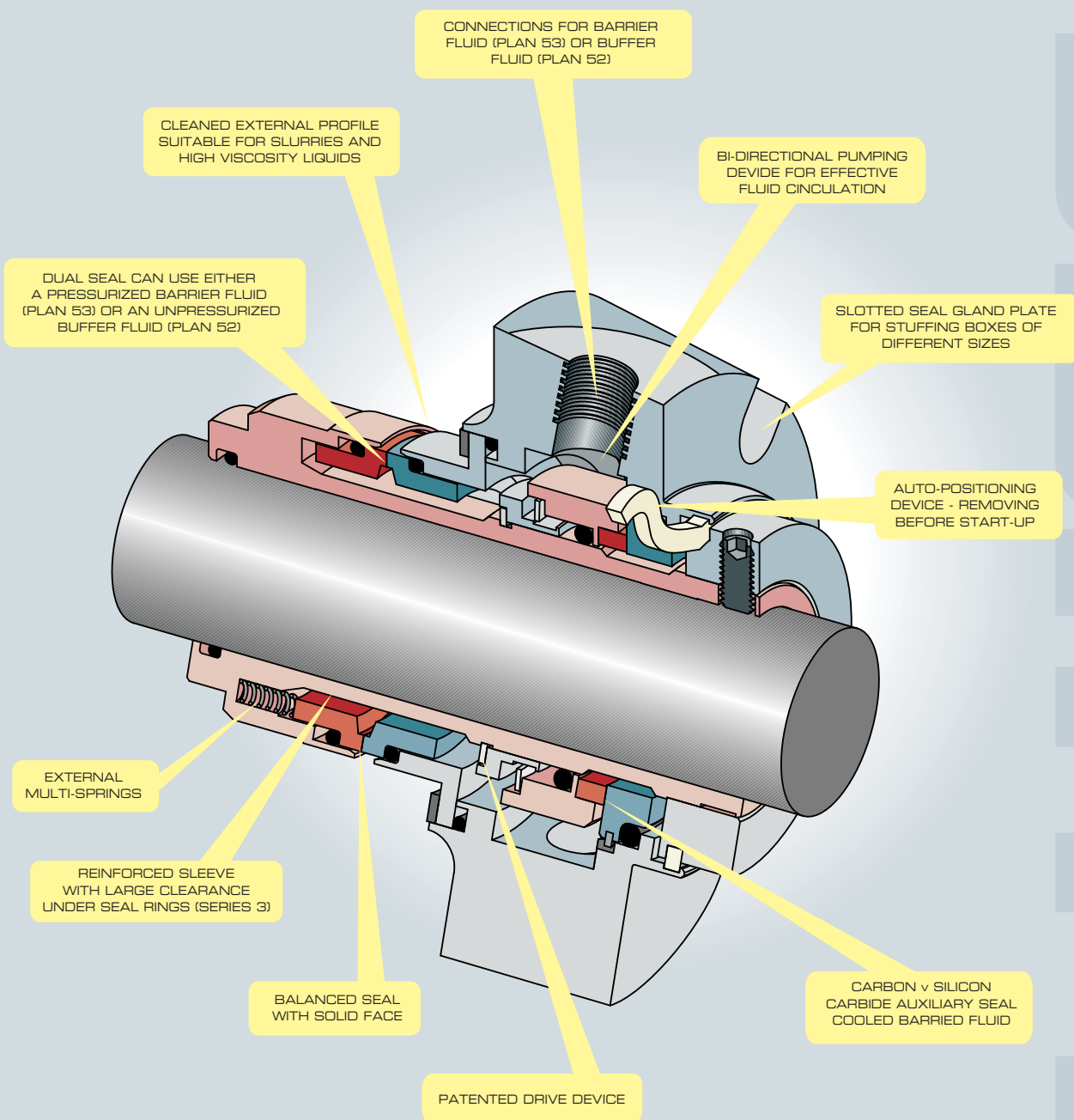

MATERIALS:

PRODUCT SIDE		ATMOSPHERE SIDE	
STATIONARY SEAT: Graphite Silicon carbide Tungsten carbide	SPRINGS: AISI 316 Hastelloy (if request)	STATIONARY SEAT: Silicon carbide	THROTTLE BUSHING (C2DQ/C3DQ/C4DQ): Bronze
ROTARY FACE: Silicon carbide Tungsten carbide	OTHER METAL PARTS: AISI 316 Hastelloy (if request)	ROTARY FACE: AISI 316+graphite	SPRING: Superinox
GASKETS: EPDM / FKM Perfluoroelastomers		GASKETS: EPDM / FKM Perfluoroelastomers (if request)	

MAIN CHARACTERISTICS



BI-DIRECTIONAL
Can be installed on clockwise or anti-clockwise rotating shafts.



PRICE
Engineered to reduce production costs without compromising its quality level.



RESISTANT TO ACIDS & BASES
The seal is resistant to products that are moderately chemically aggressive.



UNIVERSAL
Geometry and materials maximize its application range.



NO CATASTROPHIC FAILURES
The absence of a bellows guarantees that, in case of failure, there is no total fluid leakage.



SELF-CLEANING
The seal eliminates by centrifugal force possible particle sedimentations.



SELF-POSITIONING
Auto-positioning device removing before start-up.



LOW TURBULENCE HEAT GENERATIONS
Its internal geometry reduces the amount of heat generated by turbulences.



STOCK REDUCTION
Optimized material for stock reduction.



ROBUST
The seal includes 2 robust clutch pins resistant to vibrations, cavitations and mechanical stress.



CARTRIDGE
Seal complete of flange and shaft sleeve to guarantee reliable and easy installation.



LOW EMISSIONS
The geometry of the rings has been studied to avoid deformations and guarantee contact effectiveness.

APPLICATIONS

INDUSTRY



CHEMICAL INDUSTRY



PHARMACEUTICAL FIELD



FOOD INDUSTRY



PAPER FIELD



WATER TREATMENT

MACHINES



CENTRIFUGAL PUMPS



SIDE ENTRY MIXERS



BOTTOM ENTRY MIXERS



TOP ENTRY MIXERS



VERTICAL PUMPS

ATEX COMPLIANCE

The Cartridges FLUITEN seals range are certified according to the ATEX directive 94/9/CE (TÜV) which has defined the European requirements for equipment installed in critical potential explosive areas.

A declaration of conformity and a specific instruction manual can be supplied on demand. This documentation completes the equipment certification required for the duty validation. For high risk applications Fluiten can provide double mechanical seals lubricated and monitored by a thermocouple which has the probe located inside the stationary rings or in contact with the barrier fluid to have direct temperature relief.

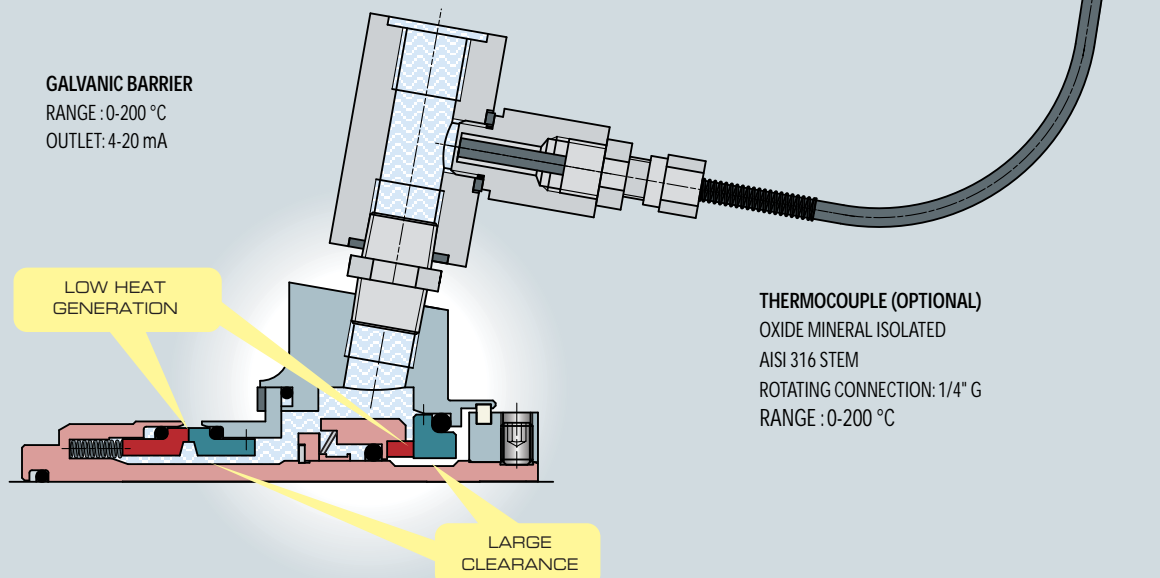

SEALS DIMENSIONS C2K - C2KC

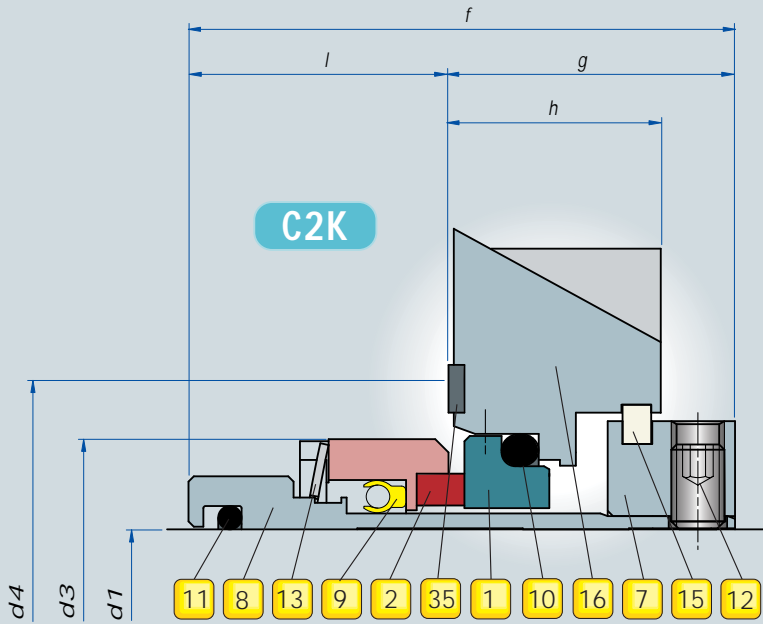

C2K

SEAL ELEMENTS:

- | | |
|----------------------------------|-------------------------------|
| 1 STATIONARY SEAT | 11 SHAFT SLEEVE GASKET |
| 2 ROTARY FACE | 12 SET SCREWS |
| 7 DRIVE COLLAR | 13 SPRING |
| 8 SHAFT SLEEVE | 15 POSITIONING DEVICE |
| 9 ROTARY FACE GASKET | 16 FLANGE |
| 10 STATIONARY SEAT GASKET | 35 FLANGE GASKET |

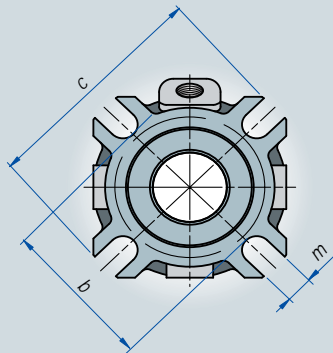

C2K e C2KC with shaft diameter ≤ 50 mm

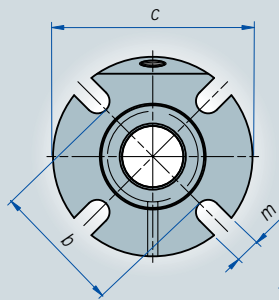

C2K e C2KC with shaft diameter > 50 mm

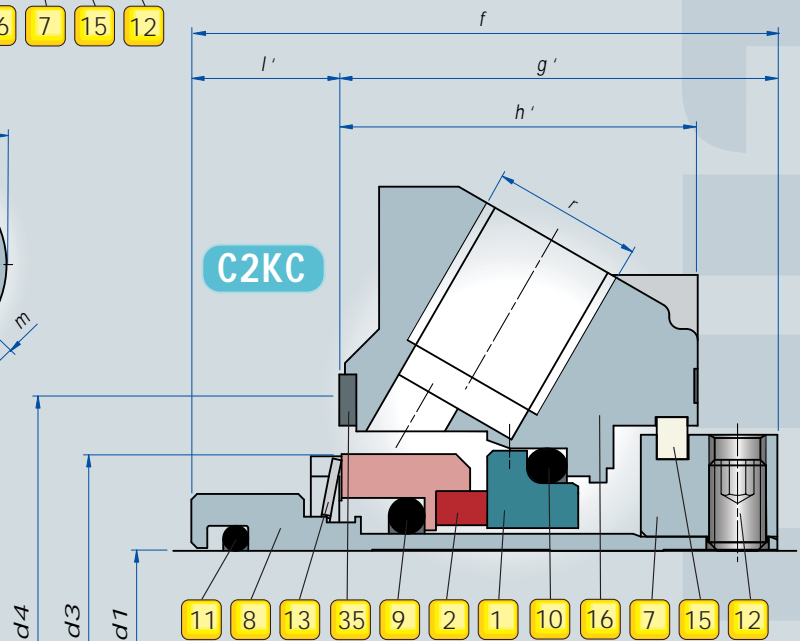

C2KC

CHARACTERISTICS:

C2K
Single cartridge seal, recommended for low duty service.
PLAN 01 or PLAN 02 (see pag. 11)

C2KC
Single cartridge seal with connection for flushing,
recommended for low duty service.
PLAN 11 or PLAN 32 (see pag. 11)

OPERATING LIMITS: (*)

DIAMETER (mm)	SPEED (m/sec)	PRESSURE (bar)	TEMPERATURE (°C)
100	12	12	+200
25	0	0	-50

(*) Pressure limitations depend upon a pressure-velocity relationship based on size, speed, face materials and fluid. Contact our Technical-Commercial office for technical specifics.

Seal Diam.	d1	d3	d4		b	c	f	g	g'	h	h'	l	l'	m	r
			min	max											
25	25	42	44	53	63	98	51.5	27	38.5	20	31.5	24.5	13	12	Rp 1/4"
28	28	45	47	53	63	98	51.5	27	38.5	20	31.5	24.5	13	12	Rp 1/4"
30	30	47	49	55	65	98	51.5	27	38.5	20	31.5	24.5	13	12	Rp 1/4"
33	33	54	56	60	68	106	55	28	39.5	20	31.5	27	15.5	12	Rp 1/4"
35	35	54	56	60	68	106	55	28	39.5	20	31.5	27	15.5	12	Rp 1/4"
38	38	57	59	68	76	120	56	29	39.5	21	31.5	27	16.5	14	Rp 1/4"
40	40	59	61	68	76	120	56	29	39.5	21	31.5	27	16.5	14	Rp 1/4"
43	43	62	64	73	81	135	56	29	39.5	21	31.5	27	16.5	14	Rp 1/4"
45	45	64	66	73	81	135	56	29	39.5	21	31.5	27	16.5	14	Rp 1/4"
48	48	67	69	79	87	148	56	29	39.5	21	31.5	27	16.5	14	Rp 1/4"
50	50	69	71	79	87	148	59	29.5	39.5	21.5	31.5	29.5	19.5	14	Rp 1/4"
55	55	78	80	84	95	148	60.5	30.5	40	22	31.5	30	20.5	18	Rp 3/8"
60	60	83	85	92	102	158	60.5	30.5	40	22	31.5	30	20.5	18	Rp 3/8"
65	65	88	90	102	112	163	60.5	30.5	40	22	31.5	30	20.5	18	Rp 3/8"
70	70	99	101	112	125	178	64.5	31.5	40	23	31.5	33	24.5	18	Rp 3/8"
75	75	104	106	117	130	185	64.5	31.5	40	23	31.5	33	24.5	18	Rp 3/8"
80	80	109	111	122	135	193	70	36	45.5	25.5	35	34	24.5	18	Rp 3/8"
85	85	114	116	126	140	198	70	36	45.5	25.5	35	34	24.5	22	Rp 3/8"
90	90	119	121	134	145	205	70	36	45.5	25.5	35	34	24.5	22	Rp 3/8"
95	95	124	126	139	150	208	70	36	45.5	25.5	35	34	24.5	22	Rp 3/8"
100	100	129	131	144	155	218	70	36	45.5	25.5	35	34	24.5	22	Rp 3/8"

Dimensions subject to modifications without notice.

SEALS DIMENSIONS C2S - C2SQ

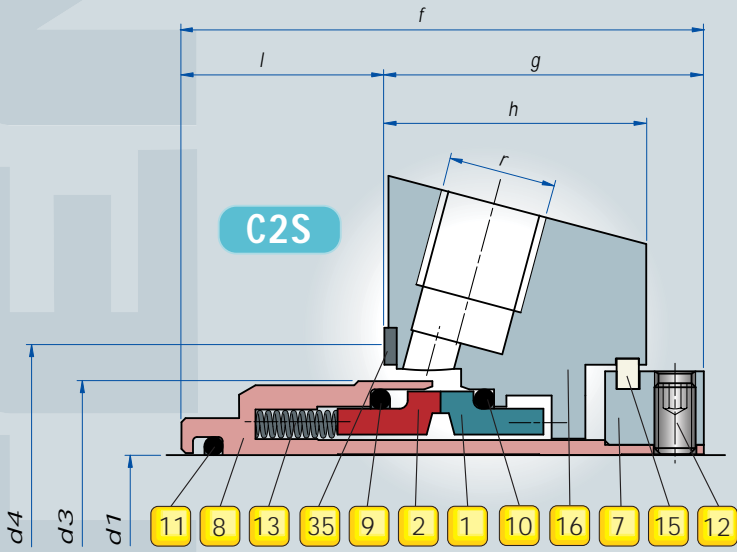

SEAL ELEMENTS:

- 1 STATIONARY SEAT
- 2 ROTARY FACE
- 7 DRIVE COLLAR
- 8 SHAFT SLEEVE
- 9 ROTARY FACE "O" RING
- 10 STATIONARY SEAT "O" RING
- 10a THROTTLE BUSHING "O" RING
- 11 SHAFT SLEEVE "O" RING
- 12 SET SCREWS
- 13 SPRINGS
- 15 POSITIONING DEVICE
- 16 FLANGE
- 35 FLANGE GASKET
- 40a SNAP RING
- 42 THROTTLE BUSHING

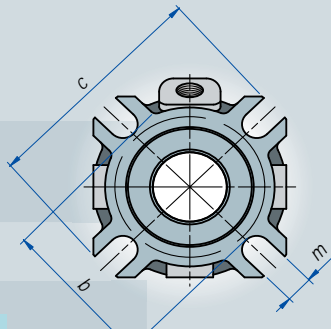

C2S with shaft diameter ≤ 50 mm

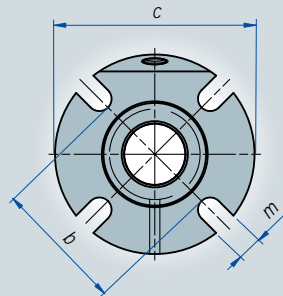

C2S with shaft diameter > 50 mm

C2SQ with shaft diameter from 25 to 100 mm

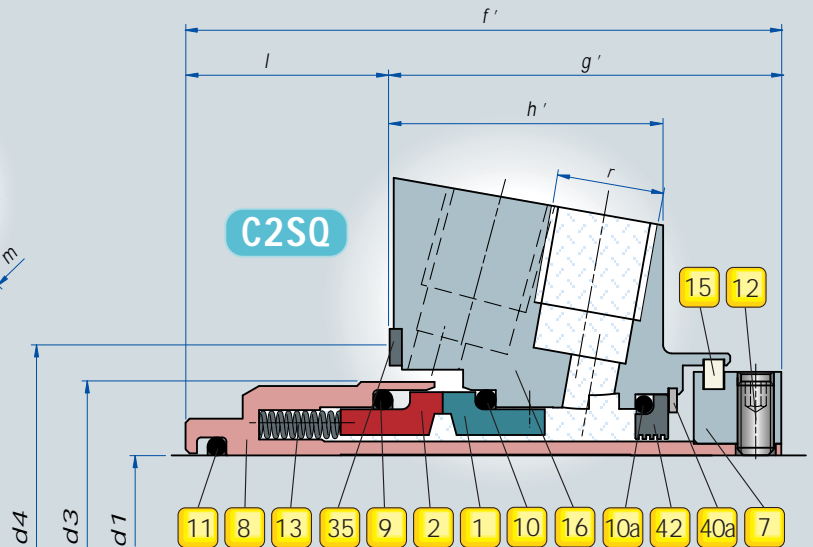

CHARACTERISTICS:

C2S
Single cartridge seal, recommended for general purpose.
PLAN 11 or PLAN 32 (see pag. 11)

C2SQ
Single cartridge seal with throttle bushing for low pressure quench (< 1 bar), recommended for general purpose.
PLAN 11/62 or PLAN 32/62 (see pag. 11)

OPERATING LIMITS: (*)

DIAMETER (mm)	SPEED (m/sec)	PRESSURE (bar)	TEMPERATURE (°C)
100	12	25	+250
25	0	0	-50

(*) Pressure limitations depend upon a pressure-velocity relationship based on size, speed, face materials and fluid. Contact our Technical-Commercial office for technical specifics.

Seal Diam.	d1	d3	d4		b	c	f	f'	g	g'	h	h'	l	m	r
			min	max											
25	25	43	44	51	63	98	63,5	74,5	38,5	49,5	31,5	33,5	25	12	Rp 1/4"
28	28	46	47	52	63	98	63,5	74,5	38,5	49,5	31,5	33,5	25	12	Rp 1/4"
30	30	48	49	56	65	98	63,5	74,5	38,5	49,5	31,5	33,5	25	12	Rp 1/4"
32	32	50	51	57	68	106	63,5	74,5	38,5	49,5	31,5	33,5	25	12	Rp 1/4"
33	33	53	54	61,5	68	106	64,5	78	39,5	53	31,5	36	25	12	Rp 1/4"
35	35	53	54	61,5	68	106	64,5	78	39,5	53	31,5	36	25	12	Rp 1/4"
38	38	56	57	66	76	120	64,5	79	39,5	54	31,5	37	25	14	Rp 1/4"
40	40	58	59	68	76	120	64,5	79	39,5	54	31,5	37	25	14	Rp 1/4"
43	43	61	62	70,5	81	135	64,5	79	39,5	54	31,5	37	25	14	Rp 1/4"
45	45	63	64	73	81	135	64,5	79	39,5	54	31,5	37	25	14	Rp 1/4"
48	48	66	67	75	87	148	64,5	79	39,5	54	31,5	37	25	14	Rp 1/4"
50	50	68	69	78	87	148	64,5	81	39,5	56	31,5	39	25	14	Rp 1/4"
55	55	73	74	83	95	148	65	82,5	40	57,5	31,5	40	25	18	Rp 3/8"
60	60	78	79	91	102	158	65	82,5	40	57,5	31,5	40	25	18	Rp 3/8"
65	65	83	84,5	98,5	112	163	65	82,5	40	57,5	31,5	40	25	18	Rp 3/8"
70	70	93	95	108	125	178	65	87,5	40	62,5	31,5	45	25	18	Rp 3/8"
75	75	98	100	113	130	185	65	87,5	40	62,5	31,5	45	25	18	Rp 3/8"
80	80	105	107	118	135	193	77	99	47	69	36,5	49	30	18	Rp 3/8"
85	85	110	113	123	140	198	77	99	47	69	36,5	49	30	22	Rp 3/8"
90	90	115	118	130	145	205	77	99	47	69	36,5	49	30	22	Rp 3/8"
95	95	121	124	135	150	208	78	100	47	69	36,5	49	31	22	Rp 3/8"
100	100	126	129	140	155	218	78	100	47	69	36,5	49	31	22	Rp 3/8"

Dimensions subject to modifications without notice.

SEALS DIMENSIONS C2D - C2DQ

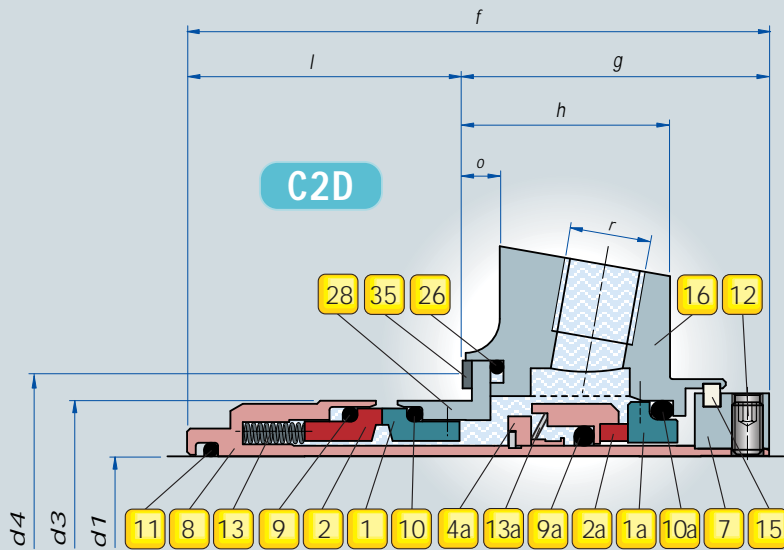

SEAL ELEMENTS:

- | | | | |
|-----|--------------------------------|-----|----------------------------------|
| 1 | STATIONARY SEAT | 10a | THROTTLE BUSHING "O" RING (C2DQ) |
| 1a | STATIONARY SEAT | 11 | SHAFT SLEEVE "O" RING |
| 2 | ROTARY FACE | 12 | SET SCREWS |
| 2a | ROTARY FACE | 13 | SPRINGS |
| 4a | SEAL BODY | 13a | SPRING |
| 7 | DRIVE COLLAR | 15 | POSITIONING DEVICE |
| 8 | SHAFT SLEEVE | 16 | FLANGE |
| 9 | ROTARY FACE "O" RING | 26 | EXTERNAL FLANGE GASKET |
| 9a | ROTARY FACE "O" RING | 35 | FLANGE GASKET |
| 10 | STATIONARY SEAT "O" RING | 40a | SNAP RING |
| 10a | STATIONARY SEAT "O" RING (C2D) | 42 | THROTTLE BUSHING |

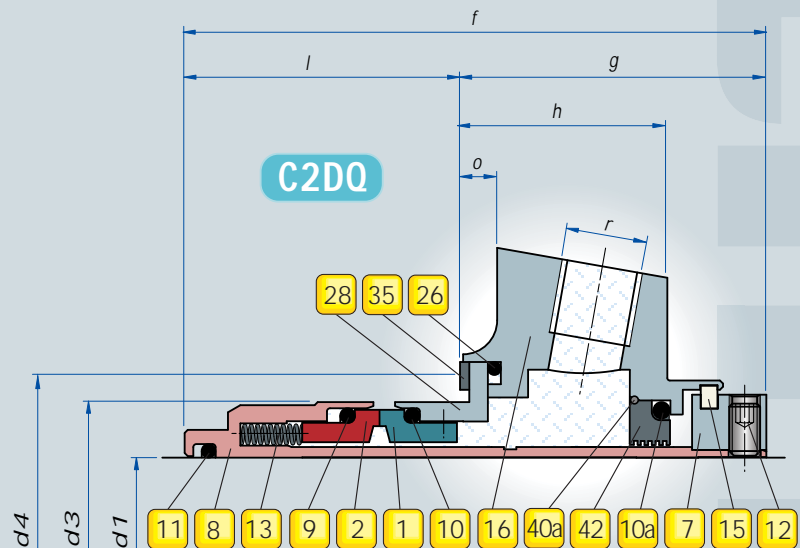
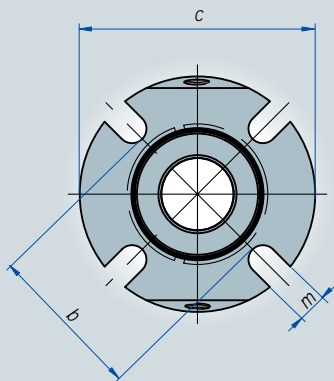

CHARACTERISTICS:

C2D

Double cartridge seal, recommended for high duty service. PLAN 52 or PLAN 53 or PLAN 54 (see pag. 11)

C2DQ

Single cartridge seal with throttle bushing for low pressure quench (< 1 bar), recommended for high duty service. PLAN 62 (see pag. 11)

OPERATING LIMITS: (*)

DIAMETER (mm)	SPEED (m/sec)	PRESSURE (bar)	TEMPERATURE (°C)
100	12	25	+250
25	0	0	-50

Externar fluid pressure:

- C2D (tandem): atmospheric pressure
- C2D (dual): 1-2 bar over product pressure

(*) Pressure limitations depend upon a pressure-velocity relationship based on size, speed, face materials and fluid. Contact our Technical-Commercial office for technical specifics.

Seal Diam.	d1	d3	d4		b	c	f	g	h	l	m	o	r
			min	max									
25	25	43	44	51	63	98	94	49,5	33,5	44,5	12	6	Rp 1/4"
28	28	46	47	52	63	98	94	49,5	33,5	44,5	12	6	Rp 1/4"
30	30	48	49	56	65	98	94	49,5	33,5	44,5	12	6	Rp 1/4"
32	32	50	51	57	67	106	94	49,5	33,5	44,5	12	6	Rp 1/4"
33	33	53	54	61,5	71	106	97,5	53	36	44,5	12	6	Rp 1/4"
35	35	53	54	61,5	71	106	97,5	53	36	44,5	12	6	Rp 1/4"
38	38	56	57	66	76	120	98,5	54	37	44,5	12	6	Rp 1/4"
40	40	58	59	68	76	120	98,5	54	37	44,5	14	6	Rp 1/4"
43	43	61	62	70,5	81	130	98,5	54	37	44,5	14	6	Rp 1/4"
45	45	63	64	73	81	135	98,5	54	37	44,5	14	6	Rp 1/4"
48	48	66	67	75	87	135	98,5	54	37	44,5	14	6	Rp 1/4"
50	50	68	69	78	87	148	100,5	56	39	44,5	14	6	Rp 1/4"
55	55	73	74	83	95	148	102	57,5	40	44,5	18	6	Rp 3/8"
60	60	78	79	91	102	158	102	57,5	40	44,5	18	6	Rp 3/8"
65	65	83	84,5	98,5	112	163	102	57,5	40	44,5	18	6	Rp 3/8"
70	70	93	95	108	125	178	107	62,5	45	44,5	18	6	Rp 3/8"
75	75	98	100	113	130	185	107	62,5	45	44,5	18	6	Rp 3/8"
80	80	105	107	118	135	193	121	69	49	52	18	6	Rp 3/8"
85	85	110	113	123	140	198	121	69	49	52	22	6	Rp 3/8"
90	90	115	118	130	145	205	121	69	49	52	22	6	Rp 3/8"
95	95	121	124	135	150	208	123	69	49	54	22	6	Rp 3/8"
100	100	126	129	140	155	218	123	69	49	54	22	6	Rp 3/8"

Dimensions subject to modifications without notice.

SEALS DIMENSIONS C3K - C3KC

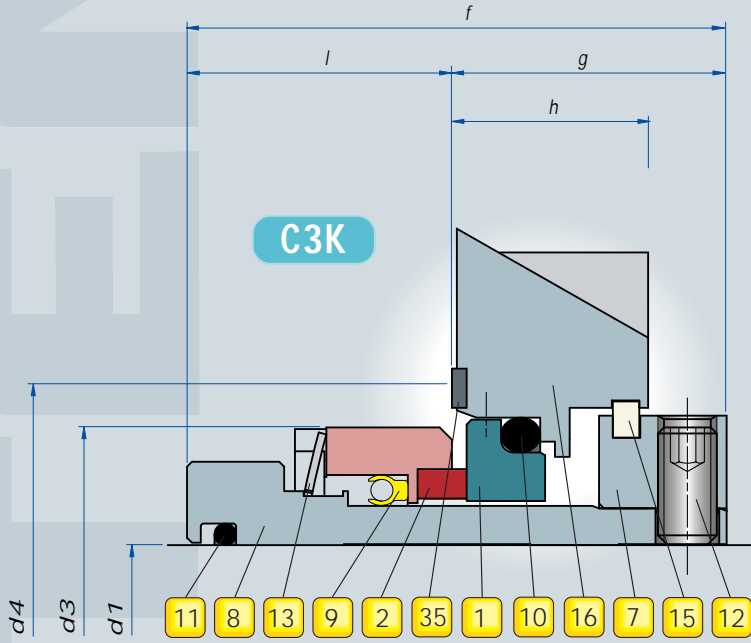

C3K

SEAL ELEMENTS:

- | | |
|---------------------------|------------------------|
| 1 STATIONARY SEAT | 11 SHAFT SLEEVE GASKET |
| 2 ROTARY FACE | 12 SET SCREWS |
| 7 DRIVE COLLAR | 13 SPRING |
| 8 SHAFT SLEEVE | 15 POSITIONING DEVICE |
| 9 ROTARY FACE GASKET | 16 FLANGE |
| 10 STATIONARY SEAT GASKET | 35 FLANGE GASKET |

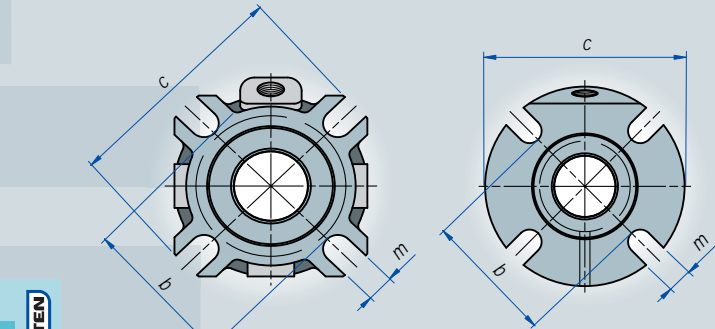

C3K e C3KC with shaft diameter ≤ 45 mm

C3K e C3KC with shaft diameter > 45 mm

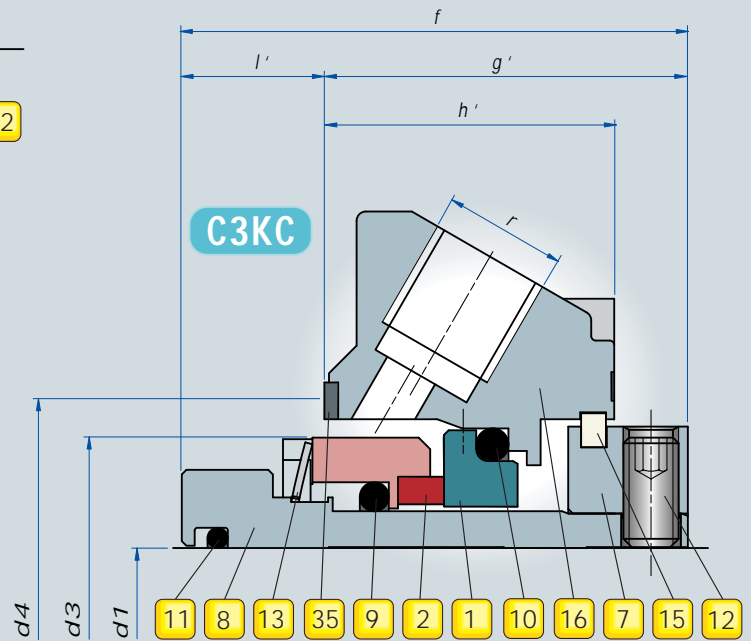

C3KC

CHARACTERISTICS:

C3K

Single cartridge seal, recommended for low duty service. PLAN 01 or PLAN 02 (see pag. 11)

C3KC

Single cartridge seal with connection for flushing, recommended for low duty service. PLAN 11 or PLAN 32 (see pag. 11)

- Reinforced sleeve.
- Important "Run-out" allowed for mixers applications.

OPERATING LIMITS: (*)

DIAMETER (mm)	SPEED (m/sec)	PRESSURE (bar)	TEMPERATURE (°C)
90	12	12	+200
20	0	0	-50

(*) Pressure limitations depend upon a pressure-velocity relationship based on size, speed, face materials and fluid. Contact our Technical-Commercial office for technical specifics.

Seal Diam.	d1	d3	d4		b	c	f	g	g'	h	h'	l	l'	m	r
			min	max											
20	20	42	44	53	63	98	51,5	27	38,5	20	31,5	24,5	13	12	Rp 1/4"
22	22	45	47	53	63	98	51,5	27	38,5	20	31,5	24,5	13	12	Rp 1/4"
25	25	47	49	55	65	98	51,5	27	38,5	20	31,5	24,5	13	12	Rp 1/4"
30	30	54	56	60	68	106	55	28	39,5	20	31,5	27	15,5	12	Rp 1/4"
33	33	57	59	68	76	120	56	29	39,5	21	31,5	27	16,5	14	Rp 1/4"
35	35	59	61	68	76	120	56	29	39,5	21	31,5	27	16,5	14	Rp 1/4"
38	38	62	64	73	81	135	56	29	39,5	21	31,5	27	16,5	14	Rp 1/4"
40	40	64	66	73	81	135	56	29	39,5	21	31,5	27	16,5	14	Rp 1/4"
43	43	67	69	79	87	148	56	29	39,5	21	31,5	27	16,5	14	Rp 1/4"
45	45	69	71	79	87	148	59	29,5	39,5	21,5	31,5	29,5	19,5	14	Rp 1/4"
48	48	78	80	84	95	148	60,5	30,5	40	22	31,5	30	20,5	18	Rp 3/8"
50	50	78	80	84	95	148	60,5	30,5	40	22	31,5	30	20,5	18	Rp 3/8"
53	53	83	85	92	102	158	60,5	30,5	40	22	31,5	30	20,5	18	Rp 3/8"
55	55	83	85	92	102	158	60,5	30,5	40	22	31,5	30	20,5	18	Rp 3/8"
58	58	88	90	102	112	163	60,5	30,5	40	22	31,5	30	20,5	18	Rp 3/8"
60	60	88	90	102	112	163	60,5	30,5	40	22	31,5	30	20,5	18	Rp 3/8"
63	63	99	101	112	125	178	64,5	31,5	40	23	31,5	33	24,5	18	Rp 3/8"
65	65	99	101	112	125	178	64,5	31,5	40	23	31,5	33	24,5	18	Rp 3/8"
68	68	104	106	117	130	185	64,5	31,5	40	23	31,5	33	24,5	18	Rp 3/8"
70	70	109	111	122	135	193	70	36	45,5	25,5	35	34	24,5	18	Rp 3/8"
75	75	114	116	126	140	198	70	36	45,5	25,5	35	34	24,5	22	Rp 3/8"
80	80	119	121	134	145	205	70	36	45,5	25,5	35	34	24,5	22	Rp 3/8"
85	85	124	126	139	150	208	70	36	45,5	25,5	35	34	24,5	22	Rp 3/8"
90	90	129	131	144	155	218	70	36	45,5	25,5	35	34	24,5	22	Rp 3/8"

Dimensions subject to modifications without notice.

SEALS DIMENSIONS C3S - C3SQ

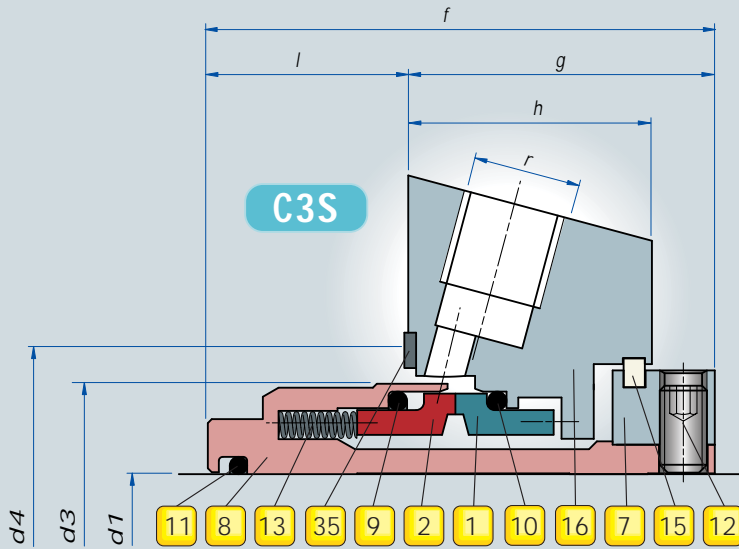

SEAL ELEMENTS:

- | | | | |
|-----|---------------------------|-----|--------------------|
| 1 | STATIONARY SEAT | 12 | SET SCREWS |
| 2 | ROTARY FACE | 13 | SPRINGS |
| 7 | DRIVE COLLAR | 15 | POSITIONING DEVICE |
| 8 | SHAFT SLEEVE | 16 | FLANGE |
| 9 | ROTARY FACE "O" RING | 35 | FLANGE GASKET |
| 10 | STATIONARY SEAT "O" RING | 40a | SNAP RING |
| 10a | THROTTLE BUSHING "O" RING | 42 | THROTTLE BUSHING |
| 11 | SHAFT SLEEVE "O" RING | | |

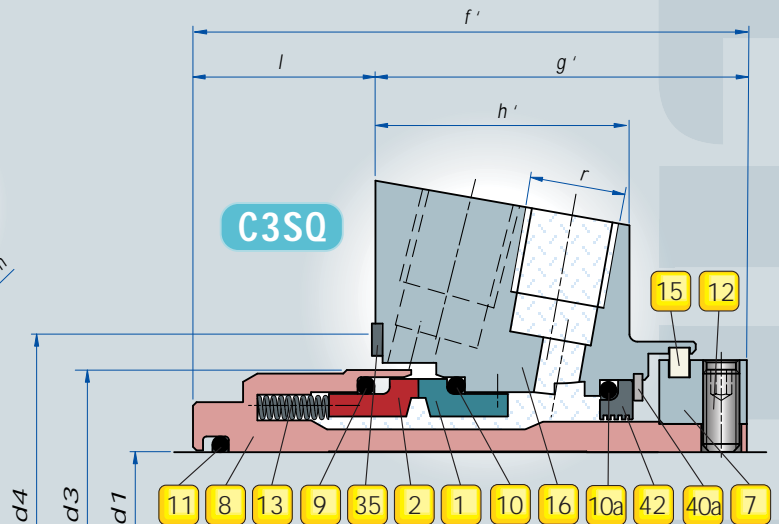
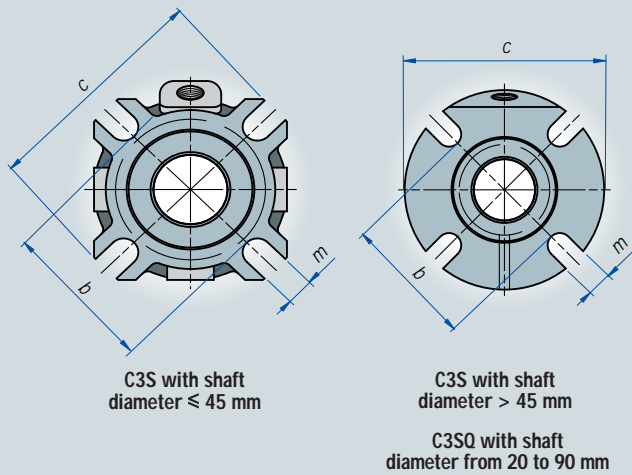

CHARACTERISTICS:

C3S
Single cartridge seal, for general purpose.
PLAN 11 or PLAN 32 (see pag. 11)

C3SQ
Single cartridge seal with throttle bushing for low pressure quench (< 1 bar), recommended for general purpose.
PLAN 11/62 or PLAN 32/62 (see pag. 11)

- Reinforced sleeve.
- Important "Run-out" allowed for mixers applications.

OPERATING LIMITS: (*)

DIAMETER (mm)	SPEED (m/sec)	PRESSURE (bar)	TEMPERATURE (°C)
90	12	25	+250
20	0	0	-50

(*) Pressure limitations depend upon a pressure-velocity relationship based on size, speed, face materials and fluid. Contact our Technical-Commercial office for technical specifics.

Shaft Diam.	d1	d3	d4		b	c	f	f'	g	g'	h	h'	l	m	r
			min	max											
20	20	43	44	51	63	98	63,5	74,5	38,5	49,5	31,5	33,5	25	12	Rp 1/4"
22	22	46	47	52	63	98	63,5	74,5	38,5	49,5	31,5	33,5	25	12	Rp 1/4"
25	25	48	49	56	65	98	63,5	74,5	38,5	49,5	31,5	33,5	25	12	Rp 1/4"
28	28	50	51	57	68	106	63,5	74,5	38,5	49,5	31,5	33,5	25	12	Rp 1/4"
30	30	53	54	61,5	68	106	64,5	78	39,5	53	31,5	36	25	12	Rp 1/4"
32	32	56	57	66	76	120	64,5	79	39,5	54	31,5	37	25	12	Rp 1/4"
33	33	56	57	66	76	120	64,5	79	39,5	54	31,5	37	25	14	Rp 1/4"
35	35	58	59	68	76	120	64,5	79	39,5	54	31,5	37	25	14	Rp 1/4"
38	38	61	62	70,5	81	135	64,5	79	39,5	54	31,5	37	25	14	Rp 1/4"
40	40	63	64	73	81	135	64,5	79	39,5	54	31,5	37	25	14	Rp 1/4"
43	43	66	67	75	87	148	64,5	79	39,5	54	31,5	37	25	14	Rp 1/4"
45	45	68	69	78	87	148	64,5	81	39,5	56	31,5	39	25	14	Rp 1/4"
48	48	73	74	83	95	148	65	82,5	40	57,5	31,5	40	25	18	Rp 3/8"
50	50	73	74	83	95	148	65	82,5	40	57,5	31,5	40	25	18	Rp 3/8"
53	53	78	79	91	102	158	65	82,5	40	57,5	31,5	40	25	18	Rp 3/8"
55	55	78	79	91	102	158	65	82,5	40	57,5	31,5	40	25	18	Rp 3/8"
58	58	83	84,5	98,5	112	163	65	82,5	40	57,5	31,5	40	25	18	Rp 3/8"
60	60	83	84,5	98,5	112	163	65	82,5	40	57,5	31,5	40	25	18	Rp 3/8"
63	63	93	95	108	125	178	65	87,5	40	62,5	31,5	45	25	18	Rp 3/8"
65	65	93	95	108	125	178	65	87,5	40	62,5	31,5	45	25	18	Rp 3/8"
68	68	98	100	113	130	185	65	87,5	40	62,5	31,5	45	25	18	Rp 3/8"
70	70	105	107	118	135	193	77	99	47	69	36,5	49	30	18	Rp 3/8"
75	75	110	113	123	140	198	77	99	47	69	36,5	49	30	22	Rp 3/8"
80	80	115	118	130	145	205	77	99	47	69	36,5	49	30	22	Rp 3/8"
85	85	121	124	135	150	208	78	100	47	69	36,5	49	31	22	Rp 3/8"
90	90	126	129	140	155	218	78	100	47	69	36,5	49	31	22	Rp 3/8"

Dimensions subject to modifications without notice.

SEALS DIMENSIONS C3D - C3DQ - C4D - C4DQ

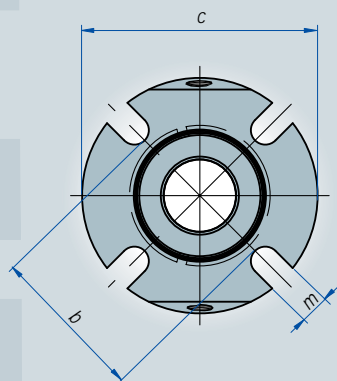
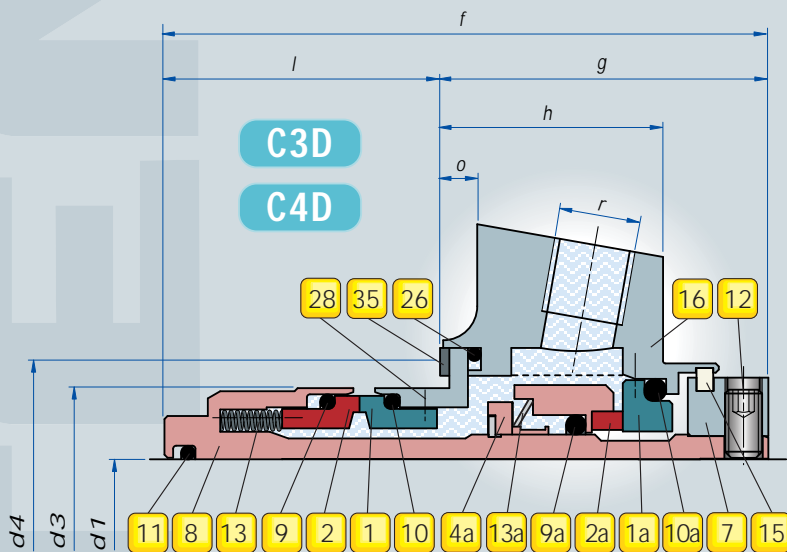

SEAL ELEMENTS:

- | | | | |
|-----|--------------------------------|-----|----------------------------------|
| 1 | STATIONARY SEAT | 10a | THROTTLE BUSHING "O" RING (C3DQ) |
| 1a | STATIONARY SEAT | 11 | SHAFT SLEEVE "O" RING |
| 2 | ROTARY FACE | 12 | SET SCREWS |
| 2a | ROTARY FACE | 13 | SPRINGS |
| 4a | SEAL BODY | 13a | SPRING |
| 7 | DRIVE COLLAR | 15 | POSITIONING DEVICE |
| 8 | SHAFT SLEEVE | 16 | FLANGE |
| 9 | ROTARY FACE "O" RING | 26 | EXTERNAL FLANGE GASKET |
| 9a | ROTARY FACE "O" RING | 35 | FLANGE GASKET |
| 10 | STATIONARY SEAT "O" RING | 40a | SNAP RING |
| 10a | STATIONARY SEAT "O" RING (C3D) | 42 | THROTTLE BUSHING |

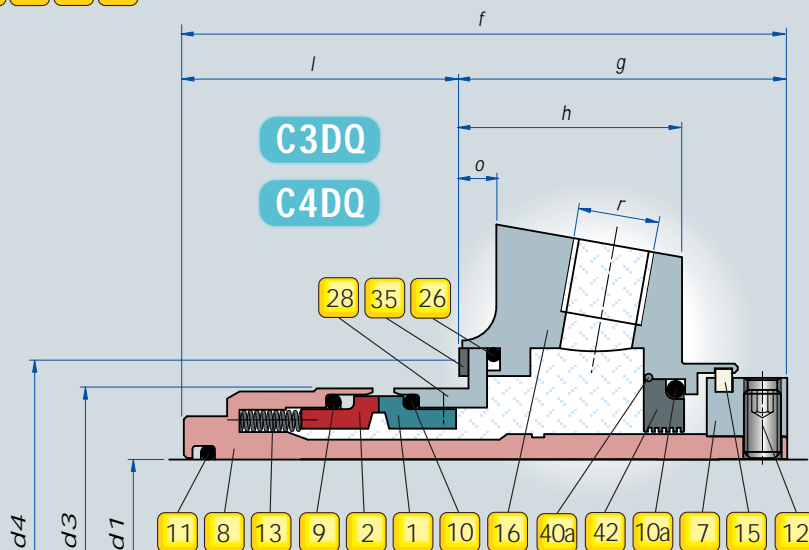

CHARACTERISTICS:

C3D
Double cartridge seal, recommended for high duty service. PLAN 52 or PLAN 53 or PLAN 54 (see pag. 11)

C3DQ
Single cartridge seal with throttle bushing for low pressure quench (< 1 bar), recommended for high duty service. PLAN 62 (see pag. 11)

C4D
Double cartridge dry-running seal. Nitrogen PLAN 54 or PLAN 02/61 with connections purchaser's use. (see pag. 11)

C4DQ
Single cartridge dry-running seal. PLAN 02 or PLAN 02/62 with throttle bushing (see pag. 11)

- Reinforced sleeve.
- Important "Run-out" allowed for mixers applications.

OPERATING LIMITS: (*)

DIAMETER (mm)	SPEED (m/sec)	PRESSURE (bar)	TEMPERATURE (°C)
90	12 (0,3 m/s for C4D/C4DQ)	25 (3 bar for C4D/C4DQ)	+250 (150 °C for C4D/C4DQ)
20	0	0	-50

Externar fluid pressure:
- C3D (tandem): atmospheric pressure
- C3D (dual): 1-2 bar over product pressure

(*) Pressure limitations depend upon a pressure-velocity relationship based on size, speed, face materials and fluid. Contact our Technical-Commercial office for technical specifics.

Seal Diam.	d1	d3	d4		b	c	f	g	h	l	m	o	r
			min	max									
20	20	43	44	51	63	98	94	49,5	33,5	44,5	12	6	Rp 1/4"
22	22	46	47	52	63	98	94	49,5	33,5	44,5	12	6	Rp 1/4"
25	25	48	49	56	65	98	94	49,5	33,5	44,5	12	6	Rp 1/4"
28	28	50	51	57	67	106	94	49,5	33,5	44,5	12	6	Rp 1/4"
30	30	53	54	61,5	71	106	97,5	53	36	44,5	12	6	Rp 1/4"
32	32	56	57	66	76	120	98,5	54	37	44,5	12	6	Rp 1/4"
33	33	56	57	66	76	120	98,5	54	37	44,5	12	6	Rp 1/4"
35	35	58	59	68	76	120	98,5	54	37	44,5	14	6	Rp 1/4"
38	38	61	62	70,5	81	130	98,5	54	37	44,5	14	6	Rp 1/4"
40	40	63	64	73	81	135	98,5	54	37	44,5	14	6	Rp 1/4"
43	43	66	67	75	87	135	98,5	54	37	44,5	14	6	Rp 1/4"
45	45	68	69	78	87	148	100,5	56	39	44,5	14	6	Rp 1/4"
48	48	73	74	83	95	148	102	57,5	40	44,5	18	6	Rp 3/8"
50	50	73	74	83	95	148	102	57,5	40	44,5	18	6	Rp 3/8"
53	53	78	79	91	102	158	102	57,5	40	44,5	18	6	Rp 3/8"
55	55	78	79	91	102	158	102	57,5	40	44,5	18	6	Rp 3/8"
58	58	83	84,5	98,5	112	163	102	57,5	40	44,5	18	6	Rp 3/8"
60	60	83	84,5	98,5	112	163	102	57,5	40	44,5	18	6	Rp 3/8"
63	63	93	95	108	125	178	107	62,5	45	44,5	18	6	Rp 3/8"
65	65	93	95	108	125	178	107	62,5	45	44,5	18	6	Rp 3/8"
68	68	98	100	113	130	185	107	62,5	45	44,5	18	6	Rp 3/8"
70	70	105	107	118	135	193	121	69	49	52	18	6	Rp 3/8"
75	75	110	113	123	140	198	121	69	49	52	22	6	Rp 3/8"
80	80	115	118	130	145	205	121	69	49	52	22	6	Rp 3/8"
85	85	121	124	135	150	208	123	69	49	54	22	6	Rp 3/8"
90	90	126	129	140	155	218	123	69	49	54	22	6	Rp 3/8"

Dimensions subject to modifications without notice.

API PLANS APPLICABLE

FOR HORIZONTAL CENTRIFUGAL PUMPS:

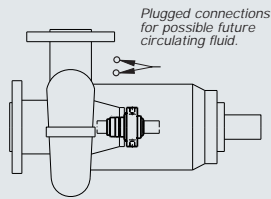

PLAN 02

Dead-ended seal chamber with no circulation of flushed fluid.

C2D0 - C3D0
With PLAN 62

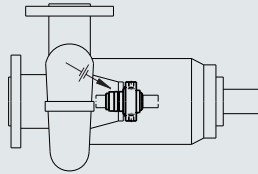

PLAN 01

Internal recirculation from pump discharge to seal.

C2K - C3K

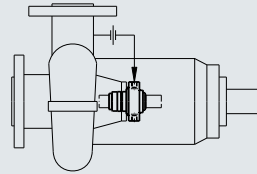

PLAN 11

Recirculation from pump case through orifice to seal.

C2KC - C3KC
C2S - C3S

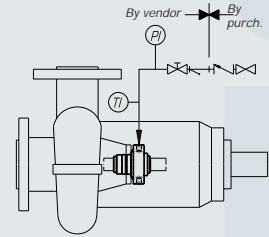

PLAN 32

Injection to seal from external source of clean fluid.

C2KC - C3KC
C2S - C3S

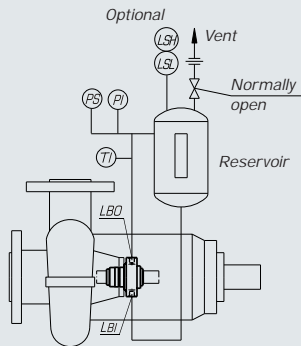

PLAN 52

Un-pressurized external fluid reservoir with forced circulation; (typically used with tandem seal arrangement)

C2D - C3D

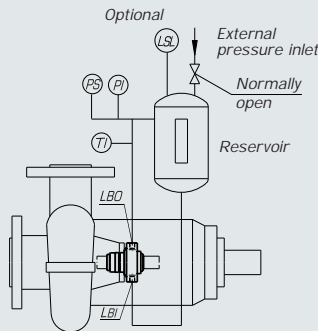

PLAN 53

Pressurized external fluid reservoir with forced circulation; (typically used with double seal arrangement)

C2D - C3D

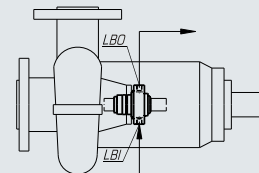

PLAN 54

Circulation of clean fluid from external system; (typically used with double seal arrangement)

C2D - C3D

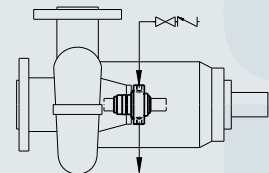

PLAN 62

External fluid quench (steam, gas, water, etc.) typically used with whit throttle bushing or auxiliary sealing device.

C2S0 - C3S0
C2D0 - C3D0

FOR TOP ENTRY MIXERS:

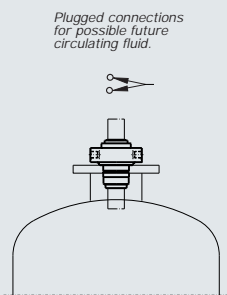

PLAN 02

Dead-ended seal chamber with no circulation of flushed fluid.

C4D - C4D0
With PLAN 62

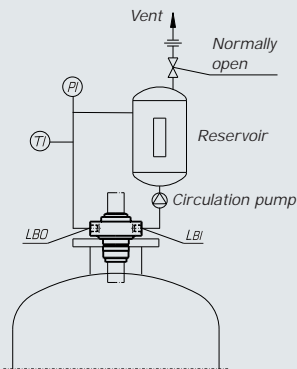

PLAN 52

Un-pressurized external fluid reservoir with forced circulation; (typically used with tandem seal arrangement)

C3D

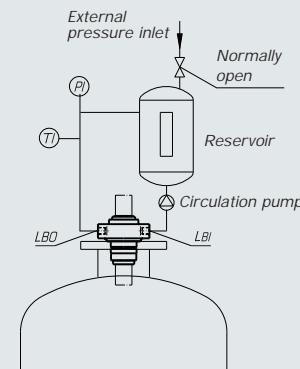

PLAN 53

Pressurized external fluid reservoir with forced circulation; (typically used with double seal arrangement)

C3D

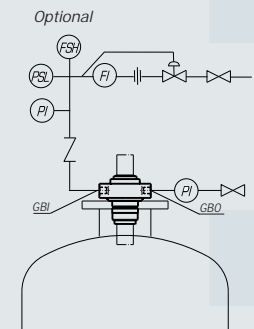

PLAN 74

Pressurized gas barrier regulated from control panel; (typically used with dry-running double seal arrangement)

C4D

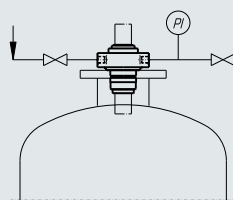

PLAN 62

External fluid quench (steam, gas, water, etc.) typically used with whit throttle bushing or auxiliary sealing device.

C3D0 - C4D0

API PLAN LEGEND

- (PI) Pressure indicator
- (TI) Temperature indicator
- (PS) Pressure switch
- (PSL) Low pressure alarm
- (LSH) High level alarm
- (LS) Low level alarm
- (FSH) High flow alarm

LBI Flushing inlet/pressurization

LBO Flushing outlet/pressurization

GBI Barrier gas inlet

GBO Barrier gas outlet

Strainer

Flow-regulation valve

Block valve

Check valve

Orifice

SERVICE SOLUTIONS

The Fluiten service department, independent from the production process, offer a fast, flexible and high quality assistance for any necessity.

During the repair process are also considered up grading evaluation to make the seals compliant to the recent environmental rules and using the present superior material technology.

High experienced technicians operates according the quality manual which define the level of repair to the initial manufacturing tolerances and performances.



Customer and After sales service for assistance and technical support tel. +39 02 339403.1 or contact us by info@fluiten.it or www.fluiten.it

Distributed by:



A strong link of your system

FLUITEN ITALIA SpA

20016 Pero (Milano) Italy • Via L. Da Vinci, 14 • Telefono +39 02. 339403.1 Fax +39 02. 3538641
www.fluiten.it E-mail: info@fluiten.it