

BS1 / Cast basket strainer EN

DESCRIPTION

Cast basket-type strainer, designed for solid particles retention in liquids and gases, suitable for all kind of applications as a protection for main equipments (pumps, valves, boilers, etc) or filtration in industrial proceses. Horizontal installation. Quick-opening cover for an easy cleaning and maintenance of the screen mesh.

SPECS & STANDARDS

Design: PED 2014/68/UE
Tests: EN12266
Sizes: DN25 up to DN150
Rating: DN25-DN50: PN40
DN65-DN150: PN16
Connections: Flanged RF acc. EN1092-1
Surface finish:
Carbon steel: painted RAL 5015
Stainless steel: shotblast

Working limits:

DN25-DN50 PN40 40 bar @ -29/120°C
DN65-DN150 PN16 16 bar @ -29/120°C

Other sizes, ratings, temperatures & connections, upon request.

AVAILABLE FILTRATION

Metallic mesh: 100, 150, 200, 300, 400, 500, 850, 1000 & 1500 micron

Perforated plate: Ø2, Ø3, Ø4, Ø5 & Ø6 mm.

Other filtration grades, please enquire.

OPTIONS

BW end connections acc. EN12627

Painted according to customer requirements.

Vent connection 1/4".

Connection to measure differential pressure.

Installation of differential pressure manometer.

Other gasket materials: EPDM or Viton.

Drainage and vent valves.

Magnetic accessory for metal debris filtration.



FEATURED SPECS

- Strong & reliable construction
- Great performance & filtration capacity
- Numerous processes applications

APPLICATIONS



Liquid Filtration

Cooling / Recovery water systems
Waste water
Protection for pumps & valves
Fuel & lubricants



Industries

Oil & Gas
Energy generation
Chemical & process
Mining

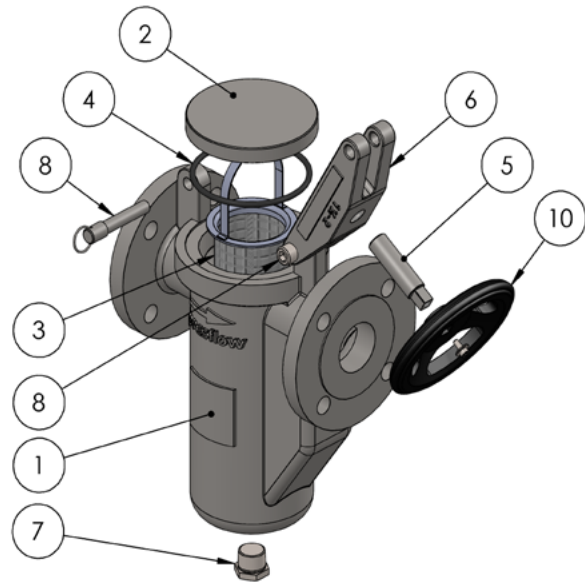
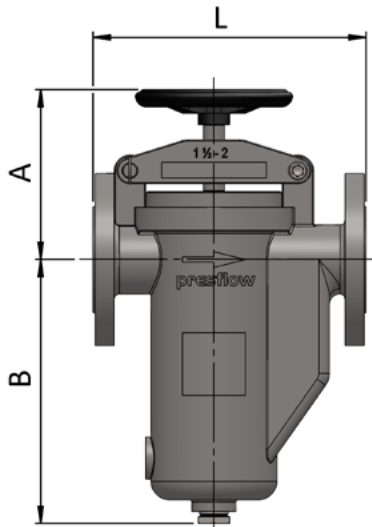

Size	Dimensions (mm.)				Weight (kg.)
	L	A	B	Drain	
DN25	210	145	165	1/2"	9
DN40	260	165	255	3/4"	20
DN50	260	165	255	3/4"	21
DN65	340	200	280	3/4"	34
DN80	340	200	280	3/4"	35
DN100	430	240	390	1"	75
DN125	430	240	390	1"	80
DN150	480	290	465	1"	107

Approximate dimensions & weights, it is subject to variations.

Part	Carbon steel	Stainless steel	
1	Body	A216 WCB	A351 CF8M
2	Cover	A216 WCB	A351 CF8M
3	Mesh screen	AISI 316L	AISI 316L
4	Gasket	NBR	
5	Closing bolt	AISI 304L	
6	Bridge	A216 WCB	A351 CF8M
7	Plug	A105	A182 F316L
8	Pin	Stainless steel	
9	Fixed bolt	Zinc plated	Stainless steel
10	Handwheel	Steel plate	

FLOW CAPACITY

Size	DN25	DN40	DN50	DN65	DN80	DN100	DN125	DN150
Kvs	20	36v	61	78	121	250	250	675

Approximate values for Ø1 mm. filtration grade.

To obtain Cv (US) = Kv x 1,156

CERTIFICATES / ADDITIONAL DOCUMENTATION*

CE mark acc. 2014/68/UE

Material & Test certificate EN10204 3.1

Manufacturing / Quality dossier

*Documentation upon request

BS1 / Cast basket strainer ANSI

DESCRIPTION

Cast basket-type strainer, designed for solid particles retention in liquids and gases, suitable for all kind of applications as a protection for main equipments (pumps, valves, boilers, etc) or filtration in industrial proceses. Horizontal installation. Quick-opening cover for an easy cleaning and maintenance of the screen mesh.

SPECS & STANDARDS

Design:	PED 2014/68/UE / API 600
Tests:	API 598
Sizes:	1" up to 6"
Rating:	1": Class 150 & 300 1 1/2" up to 6": Class 150
Connections:	Flanged RF acc. ANSI B16.5
Surface finish:	Carbon steel: painted RAL 5015 Stainless steel: shotblast
Working limits:	
Class 300:	50 bar @ -29/120°C
Class 150:	19,6 bar @ -29/120°C

Other sizes, ratings, temperatures & connections upon request.

AVAILABLE FILTRATION

Metallic mesh: 100, 150, 200, 300, 400, 500, 850, 1000 & 1500 micron

Perforated plate: Ø2, Ø3, Ø4, Ø5 & Ø6 mm.

Other filtration grades, please enquire.

OPTIONS

BW end connections acc. ANSI B16.25

Painted according to customer requirements.

Vent connection 1/4".

Connection to meure differential pressure.

Installation of differential pressure manometer.

Other gasket materials: EPDM or Viton.

Drainage and vent valves.

Magnetic accessory for metal debris filtration.



FEATURED SPECS

- Easy maintenance operations
- Great performance & filtration capacity
- Numerous processes applications

APPLICATIONS



Liquids Filtration

Cooling / Recovery water systems
Waste water
Protection for pumps & valves
Fuel & lubricants



Industries

Oil & Gas
Energy generation
Chemical & process
Mining

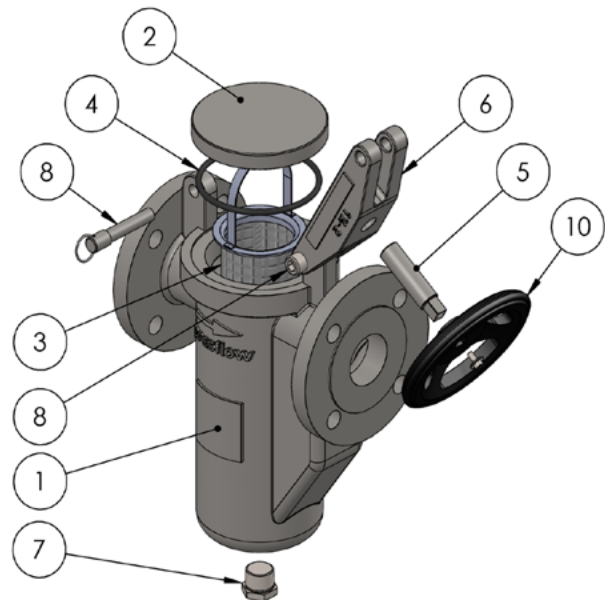
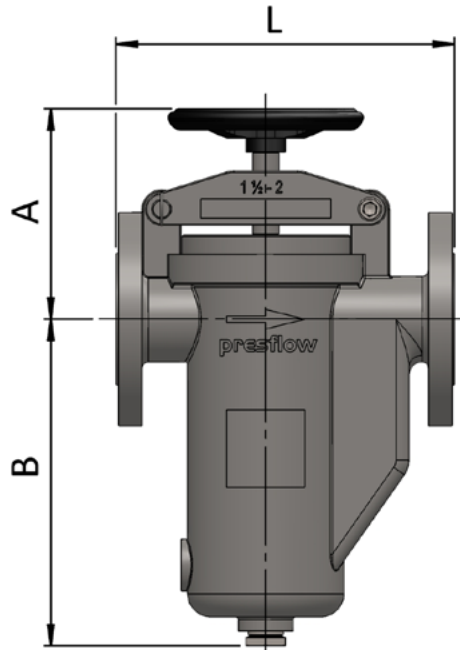

Size	Dimensions (mm.)				Weight (kg.)
	L	A	B	Drain	
1"	210	145	165	1/2"	9
1 1/2"	260	165	255	3/4"	20
2"	260	165	255	3/4"	21
2 1/2"	340	200	280	3/4"	34
3"	340	200	280	3/4"	35
4"	430	240	390	1"	75
6"	480	290	465	1"	107

Approximate dimensions & weights, it is subject to variations.

Part	Carbon steel	Stainless steel
1	Body	A216 (WCB) / A351 (CF8M)
2	Cover	A216 (WCB) / A351 (CF8M)
3	Mesh screen	AISI 316L / AISI 316L
4	Gasket	NBR
5	Closing bolt	AISI 304L
6	Bridge	A216 (WCB) / A351 (CF8M)
7	Plug	A105 / A182 F316L
8	Pin	Stainless steel
9	Fixed bolt	Zinc plated / Stainless steel
10	Handwheel	Steel plate

FLOW CAPACITY

Size	1"	1 1/2"	2"	2 1/2"	3"	4"	6"
Kvs	20	36	61	78	121	250	675

Approximate values for Ø1 mm. filtration grade.

To obtain Cv (US) = Kv x 1,156

CERTIFICATES / ADDITIONAL DOCUMENTATION*

CE mark acc. 2014/68/UE

Material & Test certificate EN10204 3.1

Manufacturing / Quality dossier

*Documentation upon request

BS2 / Basket strainer type 01/02

DESCRIPTION

Basket strainer type model BS2 designed for solid particles removal from liquids, indicated for all industrial applications. Available with quick opening cover for easy maintenance and basket mesh cleaning. Metallic basket mesh with a filtration range starting in 100 µm. Complete stainless steel housing manufacturing. Housings compatible with bag filters installationsizes 01 and 02.

SPECS & STANDARDS

Design:	EN13445 / ASME VIII
Tests:	EN12266
Sizes:	DN25/1" up to DN80/3"
Connections:	Flanged RF PN16 acc. EN1092-1 Flanged RF Class 150 acc. ANSI B16.5
Surface finish:	Stainless steel shotblast
Working limits:	10 bar@ 120°C Max. temperature 200°C with FPM gasket

Other sizes, ratings, temperatures & connections upon request.

AVAILABLE FILTRATION

Metallic mesh: 100, 150, 200, 300, 400, 500, 850, 1000, 1500 µm.
Perforated plate: Ø2, Ø3, Ø5 y Ø6 mm.
Other filtration grades, please enquire.

OPTIONS

Gaskets in EPDM, FPM o PTFE
Internal and external polished finish Ra 0,4 µm.
BW end connections
BSP or NPT end connections
Seld supporting legs
Differential pressure indicator
Drain and vent valve

CERTIFICATES /ADDITIONAL DOCUMENTATION*

CE marl acc. PED 2014/68/UE
Material & Test certificate acc. EN10204 3.1
Quality dossier
Roughness surface certificate



FEATURED SPECS

- Interchangeable filter element with bag filters sizes 01 and 02
- Easy opening for screen mesh removal
- Great value price/performance

APPLICATIONS



Liquid filtration

Process water
Paints, solvents and varnish
Acid & base chemical products



Industries

Water treatment
Chemical & fine chemical
Automotive & Surface treatments
Paper & Cellulose

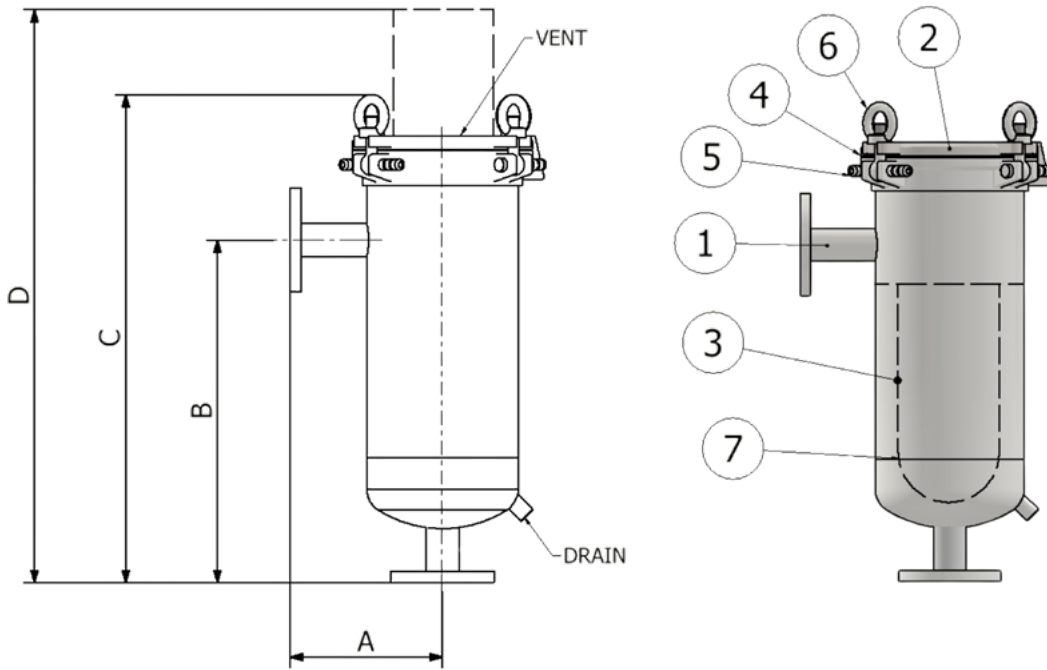

Size	Long	A	B	C	D	Vent	Drain	Weight (kg.)
DN25	01	220	495	676	965	1/4"	1/2"	33
DN25	02	220	889	1070	1753	1/4"	1/2"	41
DN40	01	220	495	676	965	1/4"	1/2"	36
DN40	02	220	889	1070	1753	1/4"	1/2"	44
DN50	01	220	495	676	965	1/4"	1/2"	38
DN50	02	220	889	1070	1753	1/4"	1/2"	46
DN65	01	220	495	676	965	1/4"	1/2"	42
DN65	02	220	889	1070	1753	1/4"	1/2"	50
DN80	01	220	495	676	965	1/4"	1/2"	44
DN80	02	220	889	1070	1753	1/4"	1/2"	52

Part	Material
1	Body AISI 316L
2	Cover A351 CF8M
3	Screen mesh AISI 316L
4*	Gasket NBR
5	Bolts A4
6	Ring bolts A4

Also available in EPDM, FPM or PTFE

BS3 / Fabricated basket strainer EN

DESCRIPTION

Welded construction strainer, designed for the retention of solid particles in liquids. A versatile unit suitable for all types of installations as a protection filter for main and auxiliary equipment, as well as for final product process. Horizontal installation, with easy basket mesh removal and cleaning. Standard bolted cover with optional quick-opening design.

SPECS & STANDARDS

Design:	EN13445 / PED 2014/68/UE
Tests:	EN12266
Size:	DN80 up to DN600
Rating:	PN10 - PN16 - PN40
Connections:	RF Flanged PN10, PN16 or PN40 EN1092-1
Surface finish:	Carbon steel: Painted RAL 5015 Stainless steel: Shotblast
Working limits:	PN10: 10 bar @ 50°C / 5,9 bar @ 400°C PN16: 16 bar @ 50°C / 9,5 bar @ 400°C PN40: 40 bar @ 50°C / 23,8 bar @ 400°C

Other sizes, ratings, temperatures and connexion types under request.

PED CATEGORY

PED 2014/68/UE		Fluid Group 2	Fluid Group 1
PN10	DN80-DN600	4.3	I
PN16	DN80-DN600	4.3	II
PN40	DN80-DN600	II	II

AVAILABLE FILTRATION

Metallic mesh: 100, 150, 200, 250, 300, 400, 500, 850, 1000 y 1500 µm.

Perforated plate: Ø2, Ø3, Ø4, Ø5 y Ø6 mm.

Other filtration grades available upon request.

OPTIONS

Gasket in graphite, graphite/ss, NBR, EPDM, PTFE, etc.
BW welded ends acc. EN12627
Bolting in quality B7/2H or B8/8
NDT tests on welds
Other painting finishes RAL 6018, 7010, 9005, 3000, etc.



FEATURED SPECS

- Custom-made manufacturing
- Grea capacity / performace
- High temperature applications

APPLICATIONS



Liquid filtration

In take water, cooling water
Pumps and valves protection
Fuel and oils
Fire fighting systems



Industries

Oil & Gas and Energy Generation
Desalination
Process
Mining
Chemical industry

DIMENSIONS, PARTS AND MATERIALS

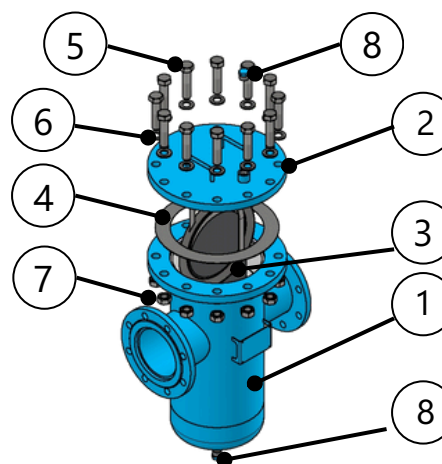
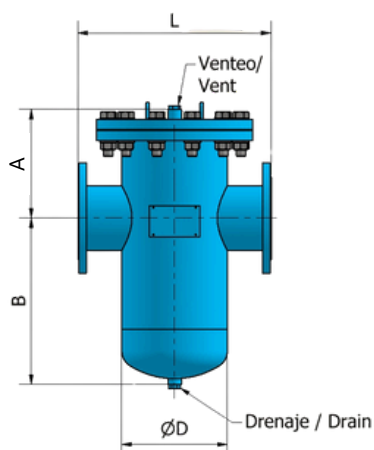

Size	Dimensions (mm.)								Weight (kg.)		Volume (l.)
	L PN16	L PN40	A	B	D	Vent	Drain	N° baskets	PN16	PN40	
DN80	430	430	240	350	219	1/2"	1/2"	1	55	65	15
DN100	430	430	240	350	219	1/2"	1/2"	1	60	70	17
DN125	450	450	240	350	219	1/2"	1/2"	1	70	80	18
DN150	480	550	270	430	273	3/4"	3/4"	1	94	110	35
DN200	600	650	300	530	323	3/4"	3/4"	1	133	145	62
DN250	730	800	365	635	355	1"	1"	1	269	285	100
DN300	850	900	400	710	406	1"	1"	1	300	320	152
DN350	980	1000	445	835	457	1"	1"	1	435	455	225
DN400	1000	1100	500	900	610	1 1/2"	1 1/2"	4	640	665	326
DN450	1000	1100	500	900	610	1 1/2"	1 1/2"	4	675	705	430
DN500	1100	1200	610	1000	711	2"	2"	4	725	755	650
DN600	1200	1300	610	1000	711	2"	2"	4	850	900	700

Part	Carbon steel	Stainless steel
1 Body	P245GH/A106B/A234WPB	AISI 316L
2 Cover	P245GH	AISI 316L
3 Screen mesh	AISI 316L	
4 Cover gasket	Fiber (optional EPDM, NBR, Graphite or Graphite/SS)	
5 Bolts	8.8 zincado	A4
6 Nuts	8.8 zincado	A4
7 Washers	8.8 zincado	A4
8 Plugs	A105	AISI 316L

- NOTES:
1. Carbon steel construction, drain and vent NPT threads as standard
 2. Stainless steel construction, drain and vent BSP threads as standard
 3. Dimensions, materials and weights are approximate, can be subject to change.
 4. Other materials available under request: Duplex stainless steel, Superduplex stainless steel, Low-temperature carbon steel, etc.

CERTIFICATES / ADDITIONAL DOCUMENTATION*

Material and test certificate EN10204 3.1

CE Declaration

Manufacturing / Quality dossier including welding procedure, test procedure, painting procedure, ITP, etc.

*Documentation under request

FLOW CAPACITY

Size	DN80	DN100	DN125	DN150	DN200	DN250	DN300	DN350	DN400	DN450	DN500	DN600
Kvs	225	250	300	692	1384	2422	3200	4411	5882	7525	9429	11418

Approximate values for a #2 mm. filtration mesh
To obtain Cv (US) = Kv x 1,156

BS3 / Fabricated basket strainer ASME

DESCRIPTION

Welded construction strainer, designed for the retention of solid particles in liquids. A versatile unit suitable for all types of installations as a protection filter for main and auxiliary equipment, as well as for final product process. Horizontal installation, with easy basket mesh removal and cleaning. Standard bolted cover with optional quick-opening design.

SPECS & STANDARDS

Design: ASME VIII Div.1 / PED 2014/68/UE
Tests: ASME VIII Div.1
Size: 3" up to 24"
Rating: Class 150# and 300#
Connections: RF Flange 150# or 300# acc. ASME B16.5
Surface finish:
Carbon steel: Painted RAL 5015
Stainless steel: Shotblast
Working limits:
Class 150#: 19,6 bar @ 50°C / 6,5 bar @ 400°C
Class 300#: 51 bar @ 50°C / 34,7 bar @ 400°C

Other sizes, ratings, temperatures and connexion types under request.



PED CATEGORY

PED 2014/68/UE		Fluid Group 2	Fluid Group 1
150#	3" - 24"	4.3	II
300#	3" - 24"	II	II

AVAILABLE FILTRATION

Metallic mesh: 100, 150, 200, 250, 300, 400, 500, 850, 1000 y 1500 µm.

Perforated plate: Ø2, Ø3, Ø4, Ø5 y Ø6 mm.

Other filtration grades available upon request.

OPTIONS

Gasket in graphite, graphite/ss, NBR, EPDM, PTFE, etc.
BW welded ends acc. EN12627
Bolting in quality B7/2H or B8/8
NDT tests on welds
Other painting finishes RAL 6018, 7010, 9005, 3000, etc.

FEATURED SPECS

- Custom-made manufacturing
- Grea capacity / performace
- High temperature applications

APPLICATIONS



Liquid filtration

In take water, cooling water
Pumps and valves protection
Fuel and oils
Fire fighting systems



Industries

Oil & Gas and Energy Generation
Desalination
Process
Mining
Chemical industry

DIMENSIONS, PARTS AND MATERIALS

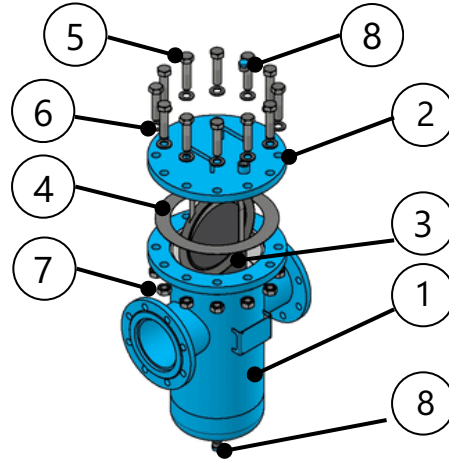
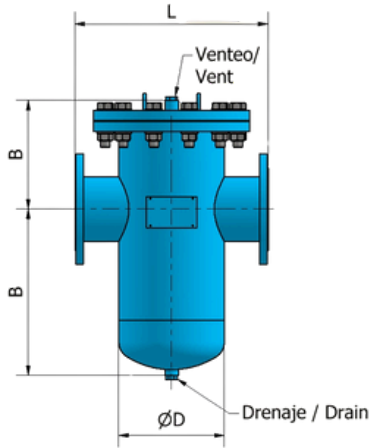

Size	Dimensions (mm.)								Weight (kg.)		Volume (l.)
	L 150#	L 300#	A	B	D	Vent	Drain	N° baskets	150#	300#	
3"	430	430	240	350	219	1/2"	1/2"	1	55	65	15
4"	430	430	240	350	219	1/2"	1/2"	1	60	70	17
5"	450	450	240	350	219	1/2"	1/2"	1	70	80	18
6"	480	550	270	430	273	3/4"	3/4"	1	94	110	35
8"	600	650	300	530	323	3/4"	3/4"	1	133	145	62
10"	730	800	365	635	355	1"	1"	1	269	285	100
12"	850	900	400	710	406	1"	1"	1	300	320	152
14"	980	1000	445	835	457	1"	1"	1	435	455	225
16"	1000	1100	500	900	610	1 1/2"	1 1/2"	4	640	665	326
18"	1000	1100	500	900	610	1 1/2"	1 1/2"	4	675	705	430
20"	1100	1200	610	1000	711	2"	2"	4	725	755	650
24"	1200	1300	610	1000	711	2"	2"	4	850	900	700

Part	Carbon steel	Stainless steel
1 Body	P245GH/A106B/A234WPB	AISI 316L
2 Cover	P245GH	AISI 316L
3 Screen mesh	AISI 316L	
4 Cover gasket	Fiber (optional EPDM, NBR, Graphite or Graphite/SS)	
5 Bolts	8.8 zincado	A4
6 Nuts	8.8 zincado	A4
7 Washers	8.8 zincado	A4
8 Plugs	A105	AISI 316L

- NOTES:
1. Carbon steel construction, drain and vent NPT threads as standard
 2. Stainless steel construction, drain and vent BSP threads as standard
 3. Dimensions, materials and weights are approximate, can be subject to change.
 4. Other materials available under request: Duplex stainless steel, Superduplex stainless steel, Low-temperature carbon steel, etc.

CERTIFICATES / ADDITIONAL DOCUMENTATION*

Material and test certificate EN10204 3.1

CE Declaration

Manufacturing / Quality dossier including welding procedure, test procedure, painting procedure, ITP, etc.

*Documentation under request

FLOW CAPACITY

Size	DN80	DN100	DN125	DN150	DN200	DN250	DN300	DN350	DN400	DN450	DN500	DN600
Kvs	225	250	300	692	1384	2422	3200	4411	5882	7525	9429	11418

Approximate values for a #2 mm. filtration mesh
To obtain Cv (US) = Kv x 1,156

MANUFACTURING OPTIONS AND CUSTOM-MADE SOLUTIONS

PRESFLOW BS3 basket strainer is a highly customizable unit, capable of adapting its design to the specific requirements of each application.

Special inlet and outlet connections

- Different sizes between inlet and outlet connections
- Inlet and outlet connection type Z or type L
- Bottom outlet with 90° elbow
- Special flanges

Special drain, vent and auxiliary connections

- Connections with WN flanges
- Flanged drain and vent connection
- Connections for DP manometer installation
- Connections for valves or sensors
- Sight glasses
- Inspection openings or Manholes

Quick cover opening systems

- Cover with davit lifting arms
- Lifting cover system with hydraulic jack
- Swing bolts for easy opening

Custom dimensions

- Inverted bottom cap for compact dimensions
- Special Face to Face dimensions

Supports and accessories

- Support legs
- Self supporting frame
- Lifting lugs
- Earthing lugs
- Isolation clips

Auxiliary elements

- Ball or butterfly valves for drain and vent connections
- Differential pressure manometer
- Absolute pressure manometer
- Sensors
- Aeration systems
- Safety valves

Internal and external finish

- Painting scheme according protective category C4, C5H, C5M, etc.
- Internal protective coatings:
Epoxy, anti-adhesion PTFE, anti-corrosive Halar o Ebonite, etc.

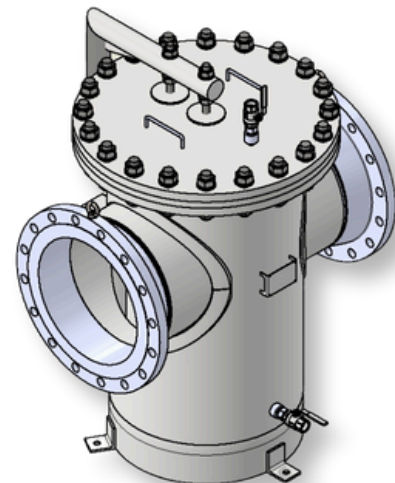
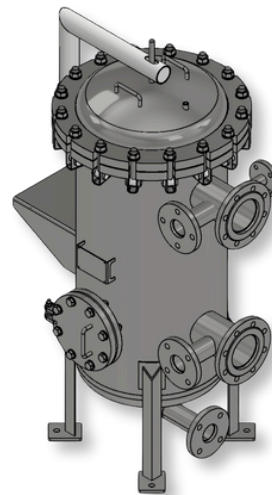
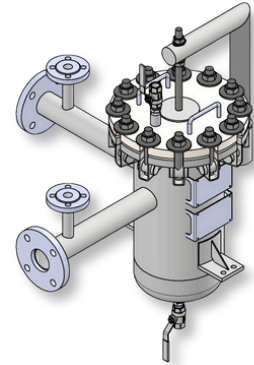
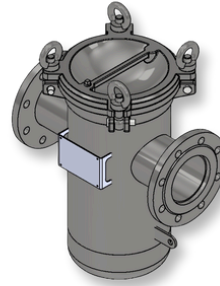

DS1 / Duplex cast basket strainer EN

DESCRIPTION

Double-body basket strainer for retaining solid particles in liquids. Operation alternately via a central control system with a three-way ball valve, allowing continuous operation without interruption during screen mesh cleaning. Includes quick opening covers for easy maintenance.

SPECS & STANDARDS

Design:	EN13445 / PED 2014/68/UE
Tests:	EN12266
Size:	DN40 up to DN80
Rating:	DN40/DN50: PN25 DN65/DN80: PN16
Connections:	RF PN16 or PN25 EN1092-1
Surface finish:	Carbon steel: Painted RAL 5015 Stainless steel: Shotblast
Working limits:	PN16: 16 bar @ -29/120°C* PN25: 25 bar @ -29/120°C*

*Available up to 200°C, upon request.

Other sizes, ratings, temperatures and connections upon request.

PED CATEGORY

PED 2014/68/UE		Fluid Group 2	Fluid Group 1
PN16	DN65-DN80	4.3	4.3
PN25	DN40-DN50	4.3	4.3

AVAILABLE FILTRATION

Metallic mesh: 100, 150, 200, 250, 300, 400, 500, 850, 1000 y 1500 µm.

Perforated plate: Ø2, Ø3, Ø4, Ø5 y Ø6 mm.

Other filtration grades, please enquire.

OPTIONS

Gaskets in EPDM or FKM, etc.

Welding end connection BW according to EN12627

Threaded connection BSP according ISO 7/1

Finish colour RAL 6018, 6021, 7010, 9005, 3000, etc.

Pressure drop indicator

By-pass

Drain valve



FEATURED SPECS

- Interchangeable with the BS1 model
- Easy operation and maintenance
- Continuous operation without interruptions

APPLICATIONS



Liquid filtration

Feed water and waste water
Pumps and valves protection
Fuel loading/unloading systems
Cooling systems



Industries

Oil & Gas and Energy generation
Desalination
Process
Mining
Chemical industry

DIMENSIONS, PARTS AND MATERIALS

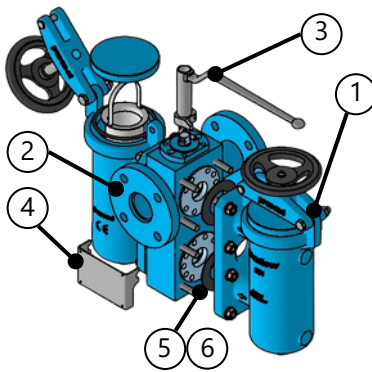
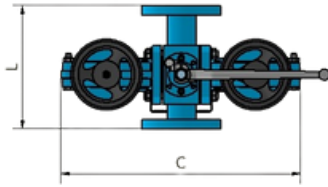
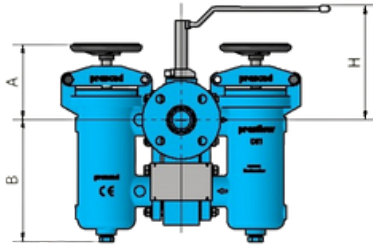

Size	L	A	B	C	H	Drain	Weight (kg.)	Volume (l.)
DN40	260	165	255	503	240	3/4" NPT	55	7
DN50	260	165	255	503	240	3/4" NPT	60	7
DN65	340	200	280	632	260	3/4" NPT	70	10
DN80	340	200	280	632	260	3/4" NPT	94	10

Part	Carbon steel	Stainless steel
1.1 Basket strainer body	A216 WCB	A351 CF8M
1.2 Basket strainer cover	A216 WCB	A351 CF8M
1.3 Basket mesh	AISI 316L	AISI 316L
1.4 Cover gasket	NBR	
1.5 Closing bolt	AISI 304L	
1.6 Bridge	A216 WCB	A351 CF8M
1.7 Plug	A105	A182 F316L
1.8 Pin	Stainless steel	
1.9 Fixed bolt	8.8 zincado	A4
1.10 Handwheel	Steel plate painted	
2.1 Valve body	P245GH	316L
2.2 3-way ball	316L	
2.3 Ball stem	316L	
2.4 Stem gasket	PTFE+GR	
2.5 Ball seat	PTFE+GR	
3 Lever	Stainless steel	
4 Nameplate support	Stainless steel	
5 Body bolting	8.8 zinc plated	A4
6 Body gasket	Fiber	

NOTES:

1. Dimensions, materials and weights are approximate, can be subject to variation.
2. Other materiales, please enquire.

OPERATION

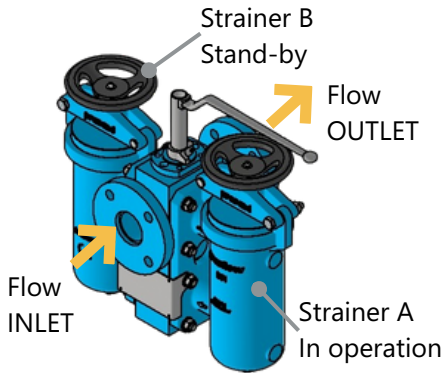

Step 1

Lever position indicates which filter is in operation.

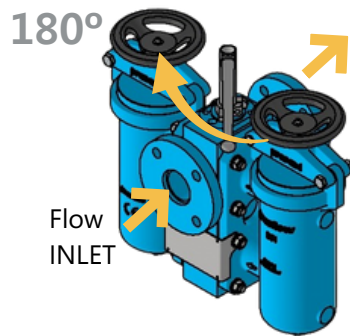

Step 2

Without stopping the flow, turn the lever 180°

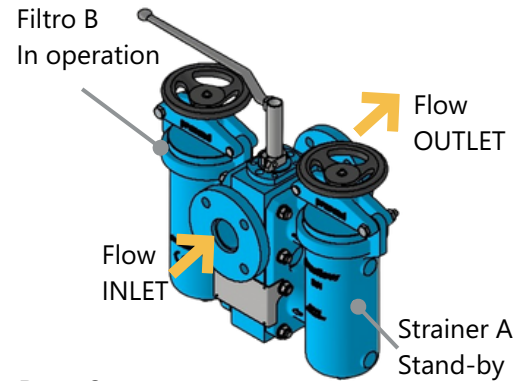

Paso 3

Strainer B in operation. Strainer A ready for maintenance.

CERTIFICATES / ADDITIONAL DOCUMENTATION*

Material and test certificate acc. EN10204 3.1

CE Declaration

Manufacturing / Quality dossier

*Documentation under request

FLOW CAPACITY

Size	DN40	DN50	DN65	DN80
Kvs	36	36	78	78

Approximated values for filtration of #2 mm.
To obtain Cv (US) = Kv x 1,156

DS1 / Duplex cast basket strainer ANSI

DESCRIPTION

Double-body basket strainer for retaining solid particles in liquids. Operation alternately via a central control system with a three-way ball valve, allowing continuous operation without interruption during screen mesh cleaning. Includes quick opening covers for easy maintenance.

SPECS & STANDARDS

Design: PED 2014/68/UE
Tests: ASME VIII Div.1
Size: 1 1/2" up to 3"
Rating: Class 150

Connections: RF flanges acc. ANSI B16.5

Surface finish:

Carbon steel: Painted RAL 5015

Stainless steel: Shotblast

Working limits:

Class 150: 19,6 bar @ -29/120°C*

*Available up to 200°C, upon request.

Other sizes, ratings, temperatures and connections upon request.



PED CATEGORY

PED 2014/68/UE		Fluid Group 2	Fluid Group 1
Class 150	1 1/2" - 3"	4.3	4.3

AVAILABLE FILTRATION

Metallic mesh: 100, 150, 200, 250, 300, 400, 500, 850, 1000 y 1500 µm.

Perforated plate: Ø2, Ø3, Ø4, Ø5 y Ø6 mm.

Other filtration grades, please enquire.

OPTIONS

Gaskets in EPDM or FKM, etc.

Welding end connection BW according to ANSI B16.25

Threaded connection NPT according ANSI B1.20.1

Finish colour RAL 6018, 6021, 7010, 9005, 3000, etc.

Pressure drop indicator

By-pass

Drain valve

FEATURED SPECS

- Interchangeable with the BS1 model
- Easy operation and maintenance
- Continuous operation without interruptions

APPLICATIONS



Liquid filtration

Feed water and waste water
Pumps and valves protection
Fuel loading/unloading systems
Cooling systems



Industries

Oil & Gas and Energy generation
Desalination
Process
Mining
Chemical industry

DIMENSIONS, PARTS AND MATERIALS

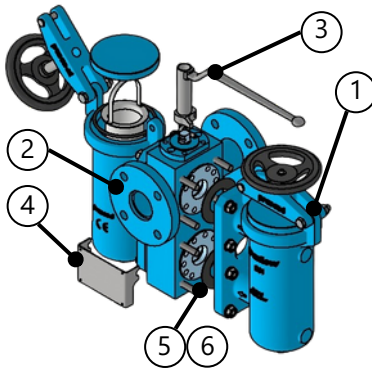
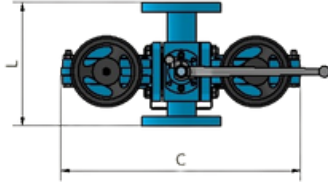
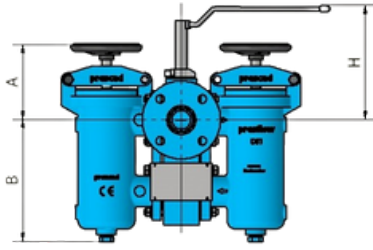

Size	L	A	B	C	H	Drain	Weight (kg.)	Volume (l.)
1 1/2"	260	165	255	503	240	3/4" NPT	55	7
2"	260	165	255	503	240	3/4" NPT	60	7
2 1/2"	340	200	280	632	260	3/4" NPT	70	10
3"	340	200	280	632	260	3/4" NPT	94	10

Part	Carbon steel	Stainless steel
1.1 Basket strainer body	A216 WCB	A351 CF8M
1.2 Basket strainer cover	A216 WCB	A351 CF8M
1.3 Basket mesh	AISI 316L	AISI 316L
1.4 Cover gasket	NBR	
1.5 Closing bolt	AISI 304L	
1.6 Bridge	A216 WCB	A351 CF8M
1.7 Plug	A105	A182 F316L
1.8 Pin	Stainless steel	
1.9 Fixed bolt	8.8 zincado	A4
1.10 Handwheel	Steel plate painted	
2.1 Valve body	P245GH	316L
2.2 3-way ball	316L	
2.3 Ball stem	316L	
2.4 Stem gasket	PTFE+GR	
2.5 Ball seat	PTFE+GR	
3 Lever	Stainless steel	
4 Nameplate support	Stainless steel	
5 Body bolting	8.8 zinc plated	A4
6 Body gasket	Fiber	

NOTES:

1. Dimensions, materials and weights are approximate, can be subject to variation.
2. Other materiales, please enquire.

OPERATION

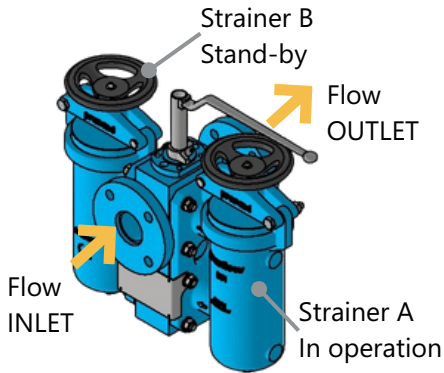

Step 1

Lever position indicates which filter is in operation.

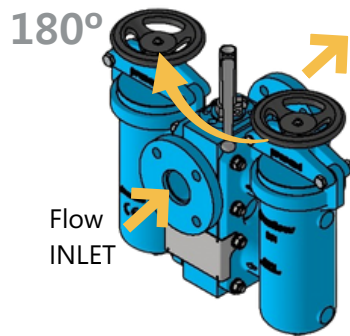

Step 2

Without stopping the flow, turn the lever 180°

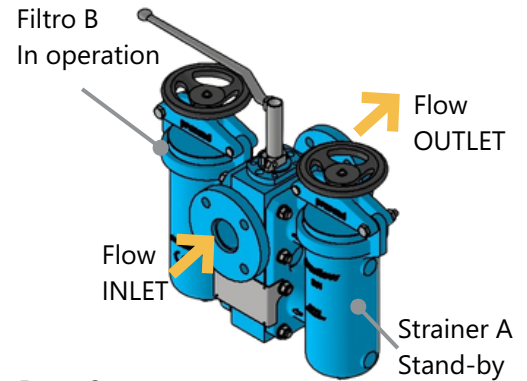

Paso 3

Strainer B in operation. Strainer A ready for maintenance.

CERTIFICATES / ADDITIONAL DOCUMENTATION*

Material and test certificate acc. EN10204 3.1

CE Declaration

Manufacturing / Quality dossier

*Documentation under request

FLOW CAPACITY

Size	1 1/2"	2"	2 1/2"	3"
Kvs	36	36	78	78

Approximated values for filtration of #2 mm.
To obtain Cv (US) = Kv x 1,156

DS2 / Duplex basket strainer - type O/D

DESCRIPTION

Double-body basket strainer designed for solid particles retention in liquids, with the possibility of alternative or parallel operation. It allows to keep working non-stop when doing the maintenance and/or cleaning at one of the basket strainers. Basket type filter elements with metallic mesh or perforated plate. Changing equipment system through different kind of valves. Removable screen mesh for an easy cleaning. It can be supplied with a self-supporting skid, if requested.

SPECS & STANDARDS

Design: PED 2014/68/UE or ASME VIII Div.1
Test: EN12266 or ASME B16.34
Sizes: DN100/4" up to DN600/24"
Rating: PN16-40/Class 150-300
Connections: Flanged RF PN16/PN40 acc. EN1092-1
Flanged RF ANSI 150/300 acc. ANSI B16.5
Materials: Carbon steel A105/WCB
Stainless steel: AISI 316L/CF8M
Surface finish:
Carbon steel: painted RAL 5015
Stainless steel: shotblast
Working limits: According to rating & material.

Other sizes, ratings, temperatures & connections upon request.

AVAILABLE FILTRATION

Metallic mesh: 100, 150, 200, 250, 300, 400, 500, 750 & 850 μm .
Perforated plate: $\varnothing 1$, $\varnothing 1'5$, $\varnothing 2$, $\varnothing 3$, $\varnothing 5$ & $\varnothing 6$ mm.
Other filtration grades, please enquire.

OPTIONS

Differential pressure gauge.
Outside paint according to customer requirements.
Manual or automatic drainage valves.
Hinged cover or Davit lifting system, for easy maintenance.
Weld ends BW connections
Self-supporting structure/skid
Valves automation
Backwash system

CERTIFICATES / ADDITIONAL DOCUMENTATION*

CE mark acc. 2014/68/UE
Material & Test certificate EN10204 3.1
Manufacturing / Quality dossier

*Documentation upon request

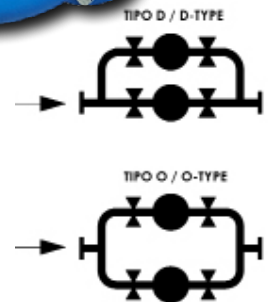
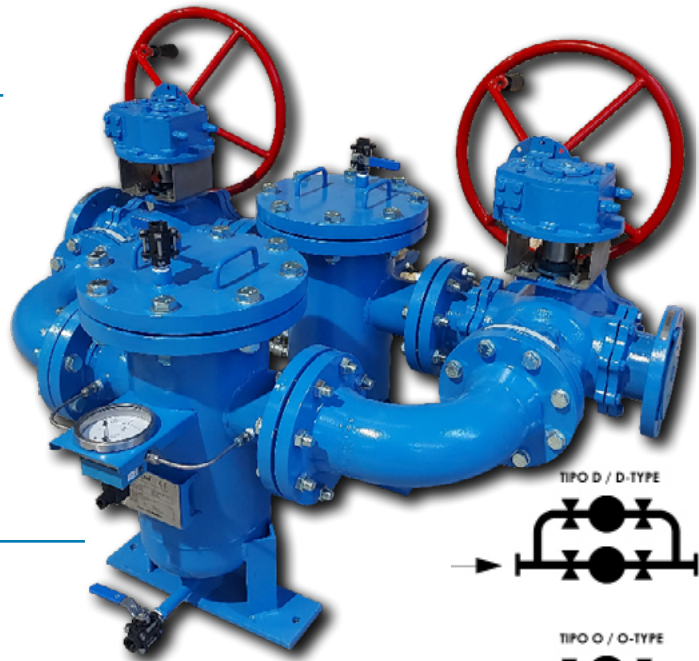

SWITCH SYSTEM

- **Butterfly valve** for low pressure and temperature.
- **3-way ball valve** for medium pressure and temperature.
- **Gate or globe valve** for high pressure and temperature.

FEATURED SPECS

- Self-supporting construction "plug&play"
- Easy operation
- High efficiency with low pressure drop

APPLICATIONS



Liquids

Water
Fuel
Oil & lubricants
Chemical products



Industries

Water treatment
Energy generation
Oil & Gas
Chemical industry
Mining

DS3 / Duplex basket strainer - type H

DESCRIPTION

Double-body basket strainer designed for solid particles retention in liquids, with alternative operation. It allows to keep working non-stop when doing the maintenance and/or cleaning at one of the basket strainers. Basket type filter elements with metallic mesh or perforated plate.

Switching system through butterfly valve, manual or automatic. Removable screen mesh for an easy cleaning. It can be supplied with a self-supporting skid, if requested.

SPECS & STANDARDS

Design:	PED 2014/68/UE or ASME VIII Div.1
Test:	EN12266 or ASME B16.34
Sizes:	DN100/4" up to DN600/24"
Rating:	PN16-40/Class 150-300
Connections:	Flanged RF PN16/PN40 acc. EN1092-1 Flanged RF ANSI 150/300 acc. ANSI B16.5
Materials:	Carbon steel: A105/WCB Stainless steel AISI 316L/CF8M
Surface finish:	Carbon steel: painted RAL 5015 Stainless steel: shotblast
Working limits:	According to rating & material.

Other sizes, ratings, temperatures & connections upon request.

AVAILABLE FILTRATION

Metallic mesh: 100, 150, 200, 250, 300, 400, 500, 750 & 850 μm .

Perforated plate: $\varnothing 1$, $\varnothing 1.5$, $\varnothing 2$, $\varnothing 3$, $\varnothing 5$ & $\varnothing 6$ mm.

Other filtration grades, please enquire.

OPTIONS

- Differential pressure gauge.
- Outside paint according to customer requirements.
- Manual or automatic drainage valves.
- Hinged cover or Davit lifting system, for easy maintenance
- Weld ends BW connections
- Self-supporting structure
- Valves automation
- Self-cleaning system

CERTIFICATES / ADDITIONAL DOCUMENTATION*

- CE mark acc. 2014/68/UE
- Material & Test certificate EN10204 3.1
- Manufacturing / Quality dossier

*Documentation upon request

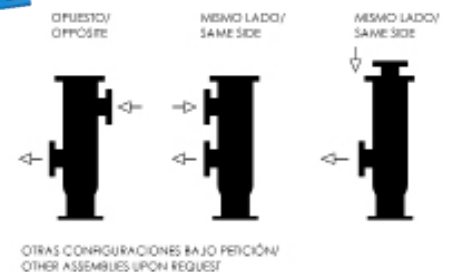

SWITCH SYSTEM

- **Butterfly valve** types: wafer, lug, welded BW, double or triple eccentric for low/high pressure applications and low/high temperature.

FEATURED SPECS

- Compact construction
- Easy operation
- High efficiency with low pressure drop

APPLICATIONS



Liquids filtration

- Cooling waters
- Fuel
- Oil & lubricants
- Chemical products



Industries

- Water treatment
- Energy generation
- Oil & Gas
- Chemical industry
- Mining

DF2 / Duplex lube filter

DESCRIPTION

Duplex housing filter specially designed for retention of solid particles in industrial application for fuel and lube oil systems. Alternative working housing to let the filter operate and do the maintenance without stopping the filtration process.

Three parts body with central changeover of 3-way type ball valve system operated with manual gearbox. Easy dismantling of basket covers for the filter element change.

SPECIFICATIONS

Design:	PED 2014/68/UE
Test:	EN12266 / ASME B31.1
Sizes:	DN50/2" up to DN150/6"
Rating:	PN16 / 150Lbs
Connections:	Flanged RF PN16 acc. EN1092-1 Flanged RF ANSI 150 acc. ANSI B16.5

Working Limits:
16 bar @ RT / 14 bar @ 120°C

Other sizes, ratings, temperatures & connections upon request.

AVAILABLE FILTRATION

Filter element available range covers filtration requirements from 4 up to 150 micron in two type of filtration medias:

- Metallic mesh: 45 and 150 µm.
- Synthetic fiber: 4, 11 and 23 µm.

Collapse pressure for filter elements is 1,5 bar.

OPTIONS

- Pressure differential indicator
- By-pass for housing pressure balance
- Drain and vent connection with ball valve.
- EPDM or FKM gaskets

CERTIFICATES / ADDITIONAL DOCUMENTATION*

- CE mark acc. 2014/68/UE
- Material & Test certificate EN10204 3.1
- Manufacturing / Quality dossier

*Documentation upon request



FEATURED SPECS

- Flow up to 1000 lpm
- Modular design
- Easy operation

APPLICATIONS



Liquids filtration

- Hydraulic oils
- Lube oils
- Compressor oils
- Light fuel
- Fuels



Industries

- Oil & Gas
- Energy generation
- Chemical
- Mining
- Maritime

DIMENSIONS, PARTS & MATERIALS

Size / Connections		Max. Flow (lpm)	Dimensions (mm.)							Weight (kg.)
EN/DIN	ANSI		A	B	C	D	E	Drain	Vent	
DN50 PN16	2" 150# RF	500	650	350	700	150	200	1/2"G	1/2"G	105
DN65 PN16	2 1/2" 150# RF	500	700	350	700	150	200	1/2"G	1/2"G	125
DN80 PN16	3" 150# RF	500	700	350	700	150	200	1/2"G	1/2"G	130
DN100 PN16	4" 150# RF	1000	790	395	766	150	250	1"G	1/2"G	175
DN150 PN16	6" 150# RF	1000	875	540	925	200	300	1"G	1/2"G	255

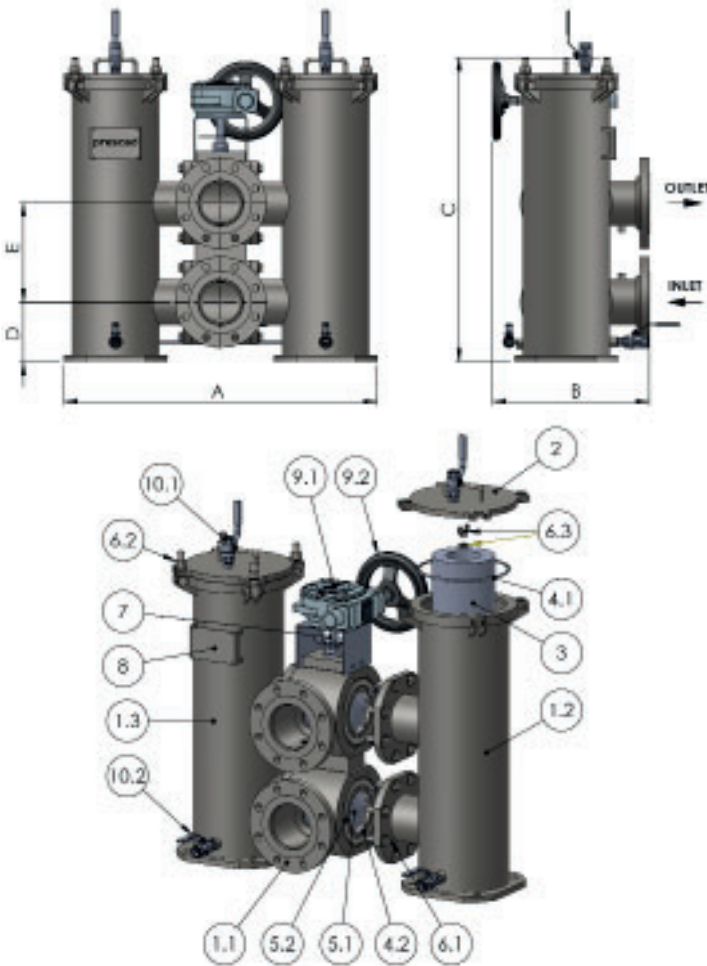

Parts	Materials	
	Carbon steel	Stainless steel
1.1 Central body	A105/A106B	AISI 316L
1.2 Basket housing	A106B/P265GH	AISI 316L
2 Basket cover	P265GH	AISI 316L
3 Filter element	Synthetic / Metallic mesh	
4.1 Cover gasket	NBR*	
4.2 Body gasket	NBR	
5.1 T-Ball	AISI 316L	
5.2 Ball seat	PTFE	
6.1 Body bolting	8.8 zinc plated	A4
6.2 Cover bolting	8.8 zinc plated	A4
6.3 Filter nut	A4	
7 Shaft	AISI 304L	
8 Nameplate	Stainless steel	
9.1 Gearbox	Casting	
9.2 Handwheel	Aluminium	
10.1 Drain valve**	AISI 316L	
10.2 Vent valve**	AISI 316L	

*Also available in EPDM and FKM

**Optional

OTHER FEATURES

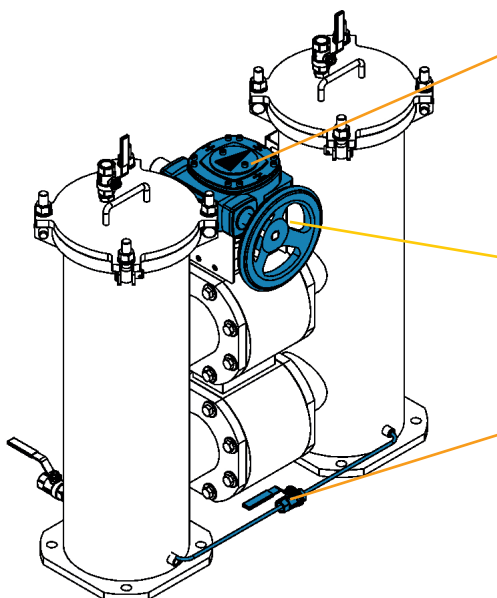

Position indicator:
Indicate working housing

Gearbox with handwheel:
Easy operation for changing the working housing

By-pass pressure balance (optional):
Housing pressure balance for an easy change of working housing

Pressure differential indicator (optional)

Indicates when filter element needs to be replaced

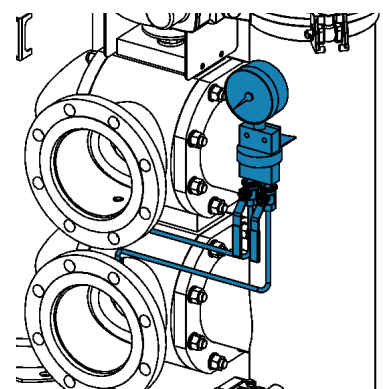

BF2 / Bag filter housing 01/02

DESCRIPTION

BF2 bag filter housing is designed for retaining solid particles in liquids. Suitable for all types of industrial applications, features a quick-opening hinged cover for easy maintenance, side inlet, and bottom outlet. Available in AISI 316L stainless steel to meet the most demanding applications.

SPECS & STANDARDS

Design:	PED 2014/68/UE EN13445/ASME VIII Div.1
Tests:	EN12266
Sizes:	DN25/1" up to DN80/3"
Connections:	RF PN16 acc. EN1092-1 RF 150# acc. ASME B16.5
Surface finish:	Shot blast / Rugosity Ra 1,6
Working limits:	10 bar @ 120° <i>Máx. temperature up to 200°C with FKM gasket</i>

Other sizes, ratings, temperatures and connections upon request.



PED CATEGORY

PED 2014/68/UE		Fluid Group 2	Fluid Group 1
PN10	DN25/1" - DN80/3"	4.3	4.3

CERTIFICATES / ADDITIONAL DOCUM.*

CE mark acc. PED 2014/68/UE
Material and test certificate acc. EN10204 3.1*
Quality dossier*
FDA approval declaration*
Roughness surface certificate*

**Documentation upon request*

FEATURED SPECS

- Wide variety of bags available
- Easy bag removal
- Available bag sizes 01 and 02

APPLICATIONS



Liquid filtration

Process water
Paints, barnishes, adhesives
Chemical products



Industries

Water treatment
Chemical industry
Food and beverages

DIMENSIONS, PARTS AND MATERIALES

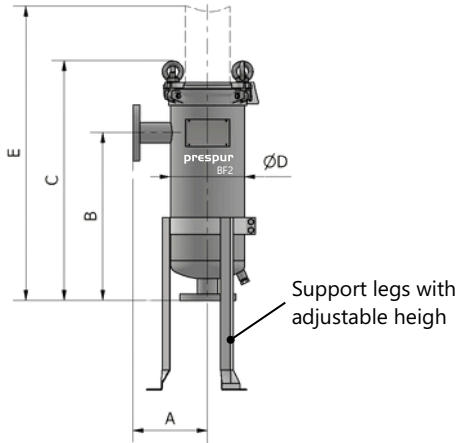

Size	Bag N°	Dimensions (mm.)						Drain	Vent	Weight (kg.)	Volume (l)
		A	B	C	ØD	E					
DN25 / 1"	01	220	495	707	219	965	1/2" G	1/4" G	33	22	
DN25 / 1"	02	220	889	1100	219	1750	1/2" G	1/4" G	41	33	
DN40 / 1 1/2"	01	220	495	707	219	965	1/2" G	1/4" G	36	22	
DN40 / 1 1/2"	02	220	889	1100	219	1750	1/2" G	1/4" G	44	33	
DN50 / 2"	01	220	495	707	219	965	1/2" G	1/4" G	38	22	
DN50 / 2"	02	220	889	1100	219	1750	1/2" G	1/4" G	46	33	
DN65 / 2 1/2"	01	220	495	707	219	965	1/2" G	1/4" G	42	22	
DN65 / 2 1/2"	02	220	889	1100	219	1750	1/2" G	1/4" G	50	33	
DN80 / 3"	01	220	495	707	219	965	1/2" G	1/4" G	44	22	
DN80 / 3"	02	220	889	1100	219	1750	1/2" G	1/4" G	52	33	

Dimensions with tolerances +/- 5 mm. Approximated weight, can be subject to variation.

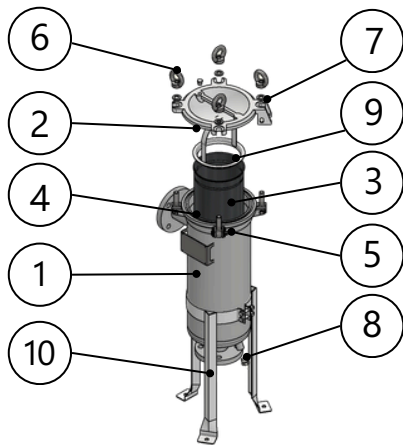

Part	Material	
1	Body housing	A351 CF8M / AISI 316L
2	Cover	A351 CF8M
3	Bag support	AISI 316L
4	Cover gasket	NBR*
5	Eye bolt	A2
6	Eye nut	A2
7	Washer	A2
8	Plug	A182 F316L
9	Bag fixation	AISI 316L
10	Support legs	AISI 304L

Other materials, please consult.

*Estándar NBR. Available also EPDM or FKM

OPTIONS

- Cover gasket in EPDM or FKM
- Internal and external polishing Ra 0,4
- Clamp connection ISO, DIN or ASME BPE
- BW end connection
- Threaded connection BSP, NPT o DIN11851
- Differential pressure indicator
- Drain and vent valve
- Design for higher pressure over 10 bar

OTHER CONFIGURATIONS

Skid assembly - Duplex configuration

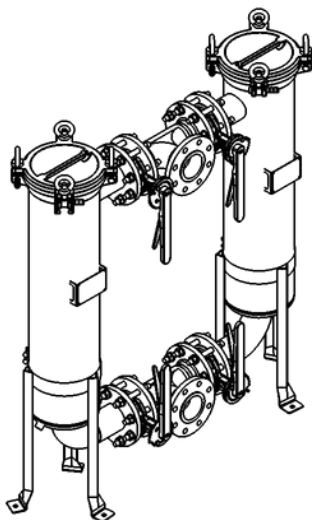

- ✓ 2 housings in paralel
- ✓ Operation with ball or butterfly valve
- ✓ Support frame (optional)
- ✓ Alternative operation:
One housing in operation +
One housing in stand by

Skid assembly - Paralel / In series housings

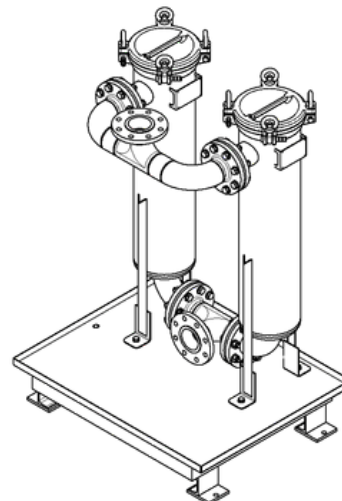

- ✓ Up to 8 housings in paralel or in series
- ✓ Operation with ball or butterfly valve
- ✓ Self-supporting frame with collection tray
- ✓ In series operation:
Variable filtration capacity adapted to different flows